



GLEBE SOCIETY COMMUNITY FESTIVAL

CELEBRATING 50 YEARS

23-30 June 2019, Harold Park Community Hall, Tramsheds, Forest Lodge
glebesociety.org.au/50th_anniversary_festival



Countdown to the Community Festival – just three weeks to go!

Things are getting very exciting as displays and events are now in the final stages of production. Thanks to a fabulous team of volunteers we are on track for our eight-day Festival to 'go live' at the Tramsheds at 11am Sunday 23 June.

When you are out and about over the next 10 days or so, you will start to see Festival banners and posters appearing; and postcards will materialise in your letterboxes and in cafes.

For more details visit the Festival website:
www.glebesociety.org.au/50th_anniversary_festival.

But most importantly ... have you booked for the Festival Launch Party?

The Festival Launch Party is being held at the Harold Park Community Hall on Sun 23 June from 4.30–7pm.

Invitations were sent out to all members a few weeks ago (most by email and some by post). If you haven't seen yours - yet check your 'junk folder', or if you need help:

- email 50th@glebesociety.org.au OR
- if you are not on line? (ie email/ website/ online booking) call Judy on 0417 446 425 to book.

The launch party is almost booked out, so we suggest you book as soon as possible if you intend to come.

If tickets are no longer available when you try to book, make sure you put your name on the waiting list, as we expect more tickets will come online as we finalise the guest list.

As well as the Exhibition, there are 17 events at the Festival which, we hope, provides something for everyone.

Some events are free and some require payment, but all require booking at Festival bookings:
<https://www.eventbrite.com.au/o/the-glebe-society-4066434169>.

If you can't book online, manual bookings are possible by contacting 50th@glebesociety.org.au or phoning Judy on 0417 446 425.

The latest Festival Schedule is included in this *Bulletin*. Check out the back page of the Schedule for useful questions and answers on the Festival.

We are looking forward to seeing you at the 50th Festival in the last week of June!

50th Anniversary Festival Steering Group
Virginia, Dorothy and Judy

**Celebrate the Society's golden anniversary.
Have you booked for a Festival event yet?**

<http://glebesociety.eventbrite.com/>

Letters to the editor

Dr Bill Nelson

Dear Virginia,

I was very saddened to learn of the death of former Society member, Dr Bill Nelson. Bill, his wife Sally and their daughter, initially lived in Alexandra Rd and then moved to 1 Allen St where they were particularly proud of their Californian bungalow and its unique garden. Bill had a pilot's licence and was one of the few Society members in favour of the construction of the third runway at Kingsford Smith Airport. He telephoned to object to the Society's policy against its construction and I had to explain that we were a democratic organisation and our policies were determined by the wishes of the majority.

Bill specialised in occupational medicine and held the senior position of Medical Director of Esso Australia, which included responsibility for the health care of those working on the Bass Strait oil platforms.

The time of Bill's retirement coincided with a need to restore the vandalised war memorial in Glebe Point Rd, so knowing Bill could have some spare hours, gave him a call and asked, 'Are you a pacifist?' His reply was 'No' and he accepted the invitation to lead a new Subcommittee to raise the funds to restore the memorial and to supervise the necessary work. The Subcommittee's decision to liaise with the National Trust was very important as it resulted in donations to the restoration appeal being tax deductible.

The results of the Subcommittee's work were outstanding and can still be admired today.

Later, Bill and Sally moved to Toulon Ave, Wentworth Falls, where they established a beautiful garden and Bill joined the local rifle club. Bill's contributions to the Society over many years were very much valued and appreciated.

Andrew Wood

A past President of the Society

Older People and Community Leadership

Hi Virginia,

I came across this:

<http://faculty.edfac.usyd.edu.au/sites/glebecdp/all-of-us-together/>. It's five video vignettes by the Glebe Community Development Program (GCDP) on community activism by older residents, and their joy in making a difference. I suspect it was made in 2009-10. Of the five older people interviewed, two – Jan Wilson and Max Solling – are currently members of the Glebe Society and make reference to the Society in their interviews.

Aunty Kath's clip is mostly about her time with Glebe Primary School's after school care program, *Centipede* (which goes back to at least the 1967 referendum);

Roelof's interview is mostly about his work through Youthies – the Glebe Youth Service; and

Marla (Priest)'s interview includes the Community Op Shop and Old Fire Station, where she still volunteers, as well as COW ('Concerned Older Women').

Cheers, Diane Hutchinson

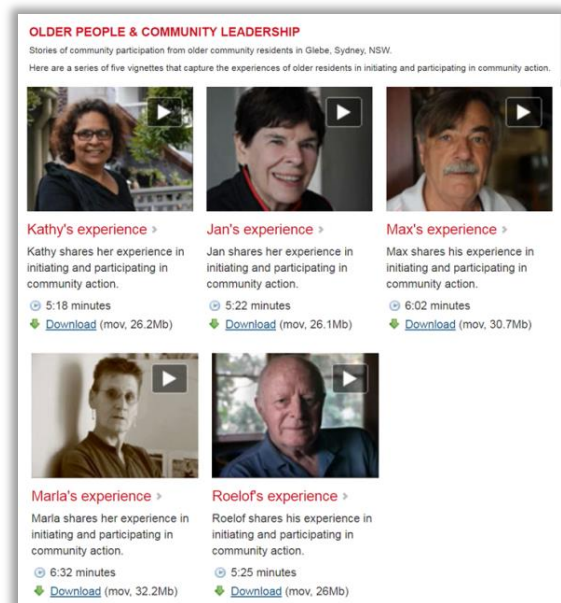

Report on 'Meet the Candidates' for the Federal election

The Glebe Society holds a 'Meet the Candidates' event for most elections, and May's Federal election was no exception.

On Saturday 4 May, over 100 people came to Glebe Town Hall to hear from then sitting member Tanya Plibersek (ALP), Matthew Thompson (Greens), Jacqui Monro (Liberal Party) and Aaron Hammond (Science Party).

Allan Hogan facilitated the panel and asked a series of questions (some curly) that had been submitted in advance by Glebe Society members. These ranged from broad policy questions to queries about local issues such as the Fishmarkets re-development. Questions were also sought from the floor and these tended to focus on environmental issues.

A special mention must go to Jacqui Monro who broke the drought of Liberal candidates who have consistently failed to attend these events. Hopefully, Jacqui was pleasantly surprised by the supportive response from the audience who seemed to admire her willingness to step into the lion's den.

Attendees would have appreciated Tanya Plibersek's laying out of Labor policy for the country and for the Sydney electorate. Matthew Thompson provided an engaging and articulate account of Greens' policy which seemed well-received by the audience. Aaron Hammond clearly outlined the need for policy to be informed by evidence, particularly scientific evidence – a position that major parties would do well to keep in mind.

The audience was a diverse mix of Glebe Society members and other interested people, including a sizeable contingent of people in 'Stop Adani' T-shirts. Some audience members no doubt expected a surprise protest from the Stop Adani group, but they – as did the great majority of attendees – abided by facilitator Allan Hogan's rule that contributions from the audience be restricted to genuine questions.

As we know, sitting member Tanya Plibersek was returned at the election on 18 May, a result that was hardly in doubt. Congratulations to the young candidates on the panel who chose to participate in the 'Meet the Candidates' session despite the expected outcome – a heartening example of democracy in action.

Virginia Simpson-Young



Glebe Society President, Verity Firth, welcomes attendees to 'Meet the Candidates'.



Tanya Plibersek and Jacqui Monro, Liberal candidate.



Greens candidate Matthew Thompson



Science Party candidate, Aaron Hammond.



A capacity audience for the 'Meet the Candidates'.



'Stop Adani' supporters

Planning Report, by Neil Macindoe

This report relates to two decisions in the Land and Environment Court.

75 Hereford Street, Yelvertoft

This Victorian Regency house stands in the middle of a large block. About 20 years ago the view of the house from Hereford St was seriously diminished by construction of several terraces along the Hereford St frontage.

Earlier this year, the owner proposed construction of similar terraces along the Alfred Rd frontage at the rear of the site. This would have impacted greatly on the curtilage of *Yelvertoft*, which is now a Heritage Item. It would also have had a major impact on Alfred Road, where recent terraces have considerable setbacks. The road currently has only partial footpaths, but considerable foot traffic.

The Commissioner refused the application on the grounds it did not achieve design excellence, as laid down in Clause 6.12 of LEP 2012. I am not

aware of this clause being used to refuse an application in Glebe previously.

This was an occasion where the community made a strong case against the proposal, and the Society supported it.

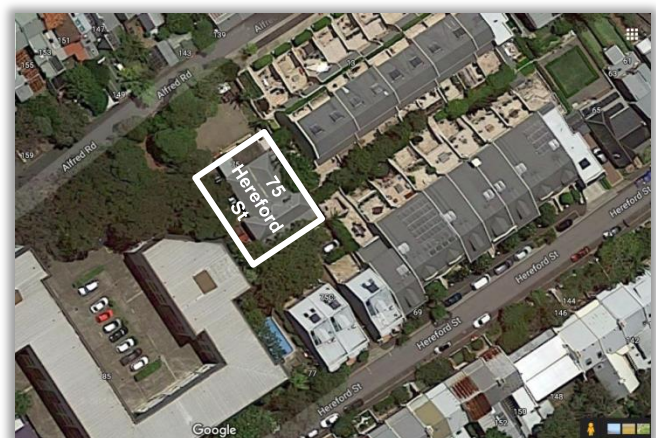

(image: adapted from Google maps)

Remand Centre 357 Glebe Point Rd

The Head Judge of the Court refused all seven grounds of appeal.

The Society opposed construction of the Remand Centre from its inception in 1980. As a result of public protest the original design was modified, but within a year of its construction it failed in its original purpose as a juvenile remand centre. For over 30 years FACS struggled to find appropriate uses for the building.

Following the sale of the site to a private developer, a proposal for multi-unit housing was submitted to Council and has been the subject of contention for the past three years. The Society argued with some success for a reduction in the height and density of the housing proposal, and the court also set stricter parameters after hearing the concerns of residents. Some local residents argued for retention of the Remand Centre as a heritage item in the 'brutalist' style. However, over two hearings the retention of the Remand Centre was not supported.

The City Council decided to appeal against this decision, a costly decision for City ratepayers and against its own staff advice. The outcome of this appeal was recently published, with the Judge

rejecting all seven arguments the Council had put forward, and the approval to demolish was reaffirmed.

The developer will now proceed along the lines approved by the Court. This will include a Design Competition as laid down by Council requirements.

Bellevue, 55A Leichhardt Street

On Wednesday, 15 May, the Local Planning Panel extended the restaurant's hours to cover from 6.30am–10pm indoors and 8am–8pm outdoors, with a maximum capacity of 120 (90 outdoors) until 6pm, and 60 after that (30 outdoors) for a trial period of 12 months.

The Society is relieved that the building will continue to be occupied and protected, and a quality service provided to residents.

Acting Convenor, Planning Subcommittee

Chris Blair has generously agreed to act in my place during my absence overseas in June and July. He can be contacted through the Society's website by sending an email to planning@glebesociety.org.au.

Neil Macindoe
Planning Convenor

GPR in 1991 and now – at the glide of your mouse!

In 1991, the Department of Planning and Environment conducted a Main Street Study of Glebe Point Rd in conjunction with a number of local organisations, including the Glebe Society. As part of the Study, photos were taken of many of the properties in the Street. In 2018, members of the Glebe Society, Ted McKeown and Lindsay Foyle, took new photos of the same properties. Peter Thorogood added some more photos in early 2019.

The GPR comparison site allows you to compare how these properties have changed in the intervening 27 years. See:

[https://www.glebesociety.org.au/about-
glebe/history-heritage/glebe-point-road-now-then/](https://www.glebesociety.org.au/about-glebe/history-heritage/glebe-point-road-now-then/).

When you go to the site, you can start viewing the properties in Glebe Point Rd by clicking on the map or by selecting a property from a list. Then drag the bar with the arrow to compare.

Give yourself plenty of time to do this – it's addictive!



247 Glebe Point Rd, built about 1960 is now the very popular Tom-Yum Tum-Gang Restaurant. In 1991 it was a hardware store. The photo shows no 247 Glebe Point Rd as it is today (on the right) and as it was in 1991 (on the left). On the website, the bar in the middle of this photo can be pulled left or right to see the complete image from either year.

Park and Playground Upgrades by the City of Sydney

Over the next 10 years, City of Sydney is planning to upgrade more than 60 parks across the City of Sydney area, from small pocket parks to larger local parks. Glebe Society members may wish to have a look at the City's plans for these parks and make comments on them before the consultation period ends on 14 June. Below are three parks in Glebe for which consultations are currently open. Details of the plans and how to comment can be accessed via the hyperlink in the right-hand column overleaf.

Ernest Pedersen Reserve

Note: Ernest Pedersen Park occupies the former front lawn of the historic villa, *Rothwell Lodge*.



<https://www.cityofsydney.nsw.gov.au/council/your-say/park-playground-upgrades/improving-ernest-pedersen-reserve-glebe#page-element-dload>

Palmerston Ave Steps & Sarah Peninton Reserve



<https://www.cityofsydney.nsw.gov.au/council/your-say/park-playground-upgrades/improving-palmerston-avenue-steps-and-sarah-peninton-glebe>

Cardigan St Reserve



<https://www.cityofsydney.nsw.gov.au/council/your-say/park-playground-upgrades/improving-cardigan-street-reserve-glebe>

Heritage & History

Bellevue decision

The Local Planning Panel (LPP) has handed down its decision on the application of *Bellevue Cottage* by *Antoine* to vary the operating conditions of its café overlooking Blackwattle Bay. While Council had recommended approval of the application with conditions, it referred the matter to the LPP for determination due to the high level of public interest and the fact that the site is owned by the City of Sydney.

The application lodged in February was notified for 14 days, resulting in 126 submissions, 33 in

objection and 93 in support. An amendment to the application resulted in 37 submissions, 13 in objection and 24 in support, all of which were from previous submitters to the earlier application.

All submitters, and the applicant, were invited to address the Panel to further express their position. The Panel made some modifications to those recommended by Council such that the amended application was approved with conditions, the following being the most significant:

- The indoor hours of operation are restricted to between 6.30am and 10pm, Monday to Sunday.
- The outdoor hours of operation are restricted to between 8am and 8 pm, Monday to Sunday.
- The venue will have a maximum capacity of 60 patrons at any time, with no more than 30 patrons outdoors.
- Notwithstanding the above, the use may operate with a maximum capacity of 120 patrons between 7am and 6pm, with no more than 90 seated outside in accordance with the approved seating plan, for a trial period of one year from 15 May 2019.

To see all the conditions of approval, copy and paste the following URL to your browser: <https://meetings.cityofsydney.nsw.gov.au/documents/d1144/Printed%20decision%20Section%204.552%20Application%2055A%20Leichhardt%20Street%20Glebe.pdf?T=5>.

Bellevue Cottage was constructed c.1896 and designed by local architect Ambrose Thornley; it is a compromised example of a modest late Victorian dwelling with some characteristics of the Italianate style. *Bellevue* is one of the few surviving examples of mid-late Victorian dwellings that characterised

Jarrett's Point on the Blackwattle Bay foreshore. (NSW Office of Environment and Heritage web site).

Bellevue Cottage is listed on the [State Heritage Register](#) and is item [no 1792 in the Sydney Local Environment Plan 2012](#).

Brian Fuller
Heritage Subcommittee convenor



The restaurant, 'Bellevue Cottage by Antoine', situated in the state heritage listed cottage, *Bellevue*. (image: <https://www.goodfood.com.au>)

Avona Avenue, by Rodney Hammett

This article follows on from Rod's article on Sheehy St in the [April Bulletin \(no. 2 of 2019\)](#), p.3. It is part of his series on the streets that resulted from the break-up of the Strathmore Estate.

The other new road created when the Strathmore Estate was subdivided in 1899 was the extension of Avona Ave with lots 12 to 18 on the eastern side, see map¹:



Sales at the initial offerings were brisk, the Evening News of Monday 28 August 1899 reporting:

The Strathmore Estate, Glebe Point, was, on Saturday afternoon, put up for auction in

allotments, by Messrs. Richardson and Wrench, under instructions from the Intercolonial Investment Company, Limited. So far, the sale realised £5,219, embracing eleven allotments and the house. Several offers for portions of the remainder are under consideration.

However, sale of the lots in Avona Ave extended over 17 years as can be seen in the list of first owners. The adjacent Avona Estate had been subdivided and put up for sale earlier that year².

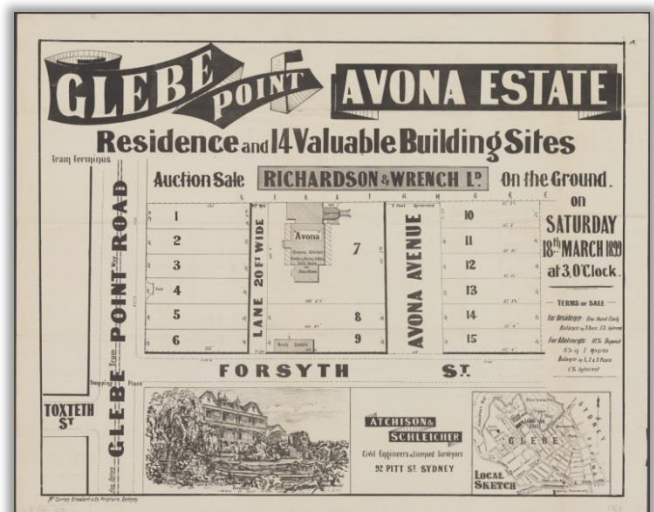

The Evening News reporting on Monday 20 March 1899:

An important suburban property, the Avona Estate, Glebe Point, was offered on the ground on Saturday afternoon by Messrs. Richardson and Wrench, Limited. There was a big attendance of the public, among whom were many well-known land speculators. Out of 15 lots offered 12 were sold, but at prices not very startling. Biddings for Avona House went to £1,150, at which low figure it was withdrawn for private treaty.

Lots from the Strathmore Estate in Avona Ave were first purchased by:

Lot No.	Purchaser	Date	House Nos
12	John Fullerton of Sydney, constable	Feb 1901	25
part 13	Henrietta Dann of Sydney, spinster	Nov 1900	27
part 13 & part 14	Emily Jane Linscott wife of Francis Linscott of Glebe Point, saw sharpener	Apr 1902	29
part 14	Annie Theresa Spahn wife of Peter Spahn of The Glebe, pastry cook	Aug 1906	31
15	Gertrude Artlett of Glebe, spinster	Aug 1900	33, 35
16	Charles Artlett of Glebe Point, share broker	Aug 1900	37, 39
17	Maria Kelly wife of William Kelly of Glebe, foundry foreman	Sep 1917	41
18	Emma Mabel Bullen wife of Charles Henry Bullen of Glebe, engineer	Mar 1912	43

Source: *Certificates of Title 1294-221 & 2037-26*

No 31 Avona Ave – Kinloch

At No. 31, the Spahn family who since 1884 had lived in Broughton St, Lyndhurst St and Talfourd St in Glebe, moved into their new house with four sons – two daughters not having survived beyond the age of two.

While pastrycook and confectioner Peter was the breadwinner it was his wife Annie who owned the house, most likely due to Peter's bankruptcy in 1891³.

At the age of eight, Prussian-born Peter (1847) arrived in Sydney as an assisted immigrant on 27 March 1855 with his parents and three siblings. His father, Franz (1816-1874), and mother, Catharina

(1823-1911), settled at William St, Double Bay to raise the family.

It was in April 1869 that Franz (also known as Francis) and 18 others were each ordered to pay a fine of 5s and 6s 6d court costs, for allowing goats, cows, and horses to stray in the borough of Woollahra⁴. Francis was often fined for such misdemeanours.

In the Water Police Court on Friday 17 February 1871 Francis was convicted 'for driving a horse attached to a cart so negligently that the omnibus of James Neil was damaged, was fined 20s and 5s costs, in default seven days in gaol'.⁵

Annie's parents, Cornelius Cronin (1821-1883) and Margaret (1826-1876), were from Ireland and arrived in Brisbane with five children in 1862⁶. Annie was born in 1864. How Peter from Sydney met Annie in Brisbane is not yet understood, nevertheless they married at St Stephen's Roman Catholic Cathedral, Brisbane on Saturday 2 July 1881⁷.

On 25 February 1908 Peter returned to Sydney, on the ship *Wimmera* from Wellington, New Zealand on which he worked as the baker.

Ten years later, on 25 June 1918, this ship while on a voyage to Sydney struck a mine left by the German raider *SMS Wolf* at the Three Islands north of Auckland, and sank. Of the 76 passengers and 75 crew, luckily, only 26 died⁸.

Peter wasn't on the ship. Unfortunately on 10 October in 1908 he fell down stairs at a hotel at the corner of Pitt St and King St, Sydney and died later that day in Sydney Hospital⁹.

That left Annie with sons Peter Francis (aged 24), Francis Sidney (20), Victor (18) and William (15).

Peter Spahn junior was already a cook and moved to Brisbane possibly to be near his mother's relatives. In July 1915, at the outbreak of WW1, Peter enlisted and served in France. Peter didn't take to the orderly life in the army, so was often in trouble. He did survive though and was discharged in 1919 returning to Brisbane. Continuing as a cook, later living at Kirra, Surfers Paradise he died in 1955 aged 71.

Francis Spahn married Iona Clark in 1914 but they were divorced in 1924 without any children. He moved to the Darlinghurst area of the city where he worked as a barman, no doubt being part of the night-life that flourished there in the 1930s, 40s and 50s. He died in September 1953 aged 65.

Victor also moved to the Darlinghurst area, describing himself as a dealer in the 1930s and 40s¹⁰. What did he deal? Was it cards or something else? He retired to Thames St Balmain in the 1950s and died there in December 1960 aged 70. Victor never married. Victor never married.

William married Madge Walsh in Glebe in 1918. He too was living in the Darlinghurst area in 1937 but after that there is no record ... perhaps he changed his surname? William and Madge didn't stay together, although there was a daughter born in Glebe in 1918 who likely became the nurse who trained at St Vincent's Hospital, married in 1949 and worked in the UK in the 1950s.

Annie continued living at No 31 until 1922 when she sold it to Kon Cassidy of Haymarket, restaurant proprietor. Aged 58 she initially lived in Darlinghurst then moved to live with her husband's relatives in the family home at 26 William St, Double Bay. This was a short walk to Double Bay beach and the shops on New South Head Rd – a very pleasant place to live. Annie died in 1941 aged 77.

The Spahn and Cassidy families must have known of each other, both being in the restaurant/food business. Kon was born in Greece in about 1890 with his original surname Cassimaty. He came to Sydney after working with the Greek communities in Perth and possibly Adelaide, no doubt learning some Australian customs along the way.

Kon married Andree Marie Louise Willemot in Sydney in 1926, so their two sons and daughter had early life experiences in Glebe and at No 31.

1930 was, of course, during the Great Depression and many were unemployed in Glebe. The Council supported a relief scheme to help the unemployed during winter with food, blankets, overcoats and boots.¹¹ Thieves were busy at the Bridge Rd warehouse premises of Bushells with a large quantity of tea stolen, valued at £54 12s 0d¹².

Those living in Avona Ave could in 1931 look across the street and still see the imposing structure of *Strathmore House* then housing homeless men and women and their children.¹³

Kon and Andree sold No 31 in April 1931 to Harry Notaras, another Greek restaurateur. The contents were sold at auction:

SUPERIOR HOUSEHOLD FURNITURE and EFFECTS

6-roomed Villa comprising bedroom and dining-room suites, overmantels, dining table, sideboard, hallstand, carpets, linos, combinations, couches,

pictures, vases, kitchen and laundry furniture, glass enclosed dresser, glassware, lawn mower, etc.¹⁴

Harry lived in Canberra having settled and opening the Highgate café in Kingston in the early days of the National Capital.¹⁵ He, with wife Helen, had three sons and a daughter. Both Harry and Helen were considered pioneers in Canberra. At the time of her death on 12 November 2007 speeches from two federal parliamentarians recorded the Notaras' contributions to the many facets of Canberrans' lives, details of which can be found in Hansard.¹⁶

Kon and Andree moved to Waverley for about three years and then to Canberra, where in 1935 he was a pastry cook possibly working for Harry Notaras. In June 1945, now a shopkeeper, Kon repurchased No 31 this time as a rental property because the family continued to live at Griffith in the ACT. Albert, their eldest son, enlisted for WW2 in August 1942 and was discharged in August 1945.

Unexpectedly, Kon died when in Royal Prince Alfred Hospital, Camperdown on 1 January 1946, aged only 56. Andree died 12 months later in Canberra aged 50.

No 31 was inherited in 1948 by John Theodore Cassidy, one of Kon's siblings, who then held it for a further 10 years. From 1931 the house was rented by numerous families.

The next instalment in this series will look at Glebe Point Rd.

Rodney Hammett

Notes: 1. National Library MAP Folder 61A, LFSP 890; 2. National Library MAP Folder 61A, LFSP 881 (Copy 1); 3. NSW Government Gazette; 4. Sydney Morning Herald; Thu 29 Apr 1869, p5; 5. Sydney Morning Herald; Sat 18 Feb 1871, p5; 6. Ancestry.com; passenger lists; 7. Telegraph (Brisbane); Mon 11 Jul 1881, p2; 8. Wikipedia [Feb 2019]; 9. Ancestry.com; Coroner's inquest 14 Oct 1908; 10. Ancestry.com; Australian Electoral Rolls; 11. Labour Daily; Fri 6 Jun 1930, p5; 12. Evening News; Fri 23 May 1930, p3; 13. Sydney Morning Herald; Tue 20 Oct 1931, p8 (The Family Hostel); 14. Sydney Morning Herald; Thu 28 Sep 1922, p13; 15. Canberra Times; 1 Jun 2013 (Canberra loses a pioneer); 16. <http://www.hansard.act.gov.au/hansard/2007/week12/3682.htm>

Environment

News from the Blue Wren Subcommittee

On 15 April 2019 at *Benledi*, a meeting was held with Daniel Harris (Community Garden and Volunteer Coordinator) and Sophie Golding (Urban Ecology Coordinator), City of Sydney, concerning the appointment of new contractors for the care and maintenance of the City's parks. Judy Christie, Robert Hannan and David Lawrence represented

the Subcommittee. CitiWide, the current contractors caring for general non-specialised maintenance, have been replaced by Skyline and the National Trust of NSW will be caring for the native flora in parks where Glebe's volunteer bushcarers are working. The National Trust contract will be supervised by Sophie. As a result

of these changes the Rozelle Bay Bushcare Group will be disbanded from 22 May 2019 when the NSW National Trust will take over the maintenance of flora in the parks near Johnstons Creek and in front of the Anchorage home units on the harbour foreshore. In the future the National Trust may reinstitute the work of the Rozelle Bay Bushcare volunteers.

Rae Broadfoot, the City's former Community Garden and Volunteer Coordinator, who had been battling cancer, died on 3 May 2019. The Subcommittee was very saddened to learn of her death as we had worked with Rae from the time of her appointment to the City of Sydney and valued her support and enthusiasm for the bushcare and landcare volunteers in our suburb and generally in the Local Government Area. Her appointment to the City's staff was innovative and provided a leadership position which was very much needed to assist with the work of so many volunteers. We asked that the City pass on our condolences to Rae's family and friends.

Applications for the 2019 Craney Small Grants have been posted to the 13 preschools, primary and high schools in our area with a submission deadline of 30 June 2019. The program is named in honour of Jan Craney, a respected and much-loved former convenor and member of the Subcommittee. In her will, Jan left the Subcommittee a bequest to foster biodiversity in our suburb's parks and gardens. Jan was particularly interested in the education of children leading to an increased awareness of the value of native plants and animals in our suburb. The grants will fund activities or purchase items that will assist children to engage with and learn about the natural environment and the opportunities in our area to help improve habitat for wildlife.

The annual biodiversity lecture organised by the Subcommittee will be held as part of the Society's 50th anniversary celebrations. Shauna Chadlowe, the Chief Development Officer for Australian Wildlife Conservancy, will deliver a talk entitled

Fighting Back: 'Restoring Australia's Unique Biodiversity' in the Tramsheds, at 6 pm Friday 28 June; afterwards the Subcommittee will provide wine and nibbles. All Society members and friends are welcome to attend and there will be no charge for the event. Online bookings can be made here: <https://www.eventbrite.com.au/e/fighting-back-restoring-australias-unique-biodiversity-tickets-62195729100>.

In Paddy Gray Reserve, volunteers have continued to water the native flora over the summer. As the group has only three members, it has not been possible to ensure that all areas of the park are looked after.

Bryan Herden, the leader of the group, had an onsite meeting with Daniel Harris from the City to discuss the future role of the NSW National Trust and the need for many days work to catch-up on the maintenance of the park.

If you would like to volunteer to help care for the park, please telephone Bryan (0425 396 265). Over the summer the Ferry Road Bushcare Group (Ernest Pederson Park, William Carlton Gardens and Quarry Lane) has also continued watering and weeding.

Andrew Wood

Convenor, Blue wrens Subcommittee

E-waste collections

The next e-waste drop-off day for City of Sydney residents is Saturday 8 June 2019 from 9am to 3pm at the Alexandra Canal Depot, 67C Bourke Rd, Alexandria.

Last year, 90 tonnes of electronic waste were recycled; this was from more than 2,800 households. Later this year, City of Sydney will start kerbside e-waste collection, so 'we can divert even more e-waste from landfill, recycle valuable metals, and keep harmful chemicals out of landfill sites'.

Community Matters

Dementia

Can Glebe become a 'dementia-friendly community'?



A dementia-friendly community is a place where people living with dementia are supported to live a high quality of life with meaning, purpose and value. For more information about how this can be achieved, go to

<https://www.dementiafriendly.org.au>.

Dementia Friends Community Awareness Event in Glebe

Are you interested in supporting people living with dementia in your community? This free information session will provide an overview of the impact of dementia on the person with dementia and their families. The session will also discuss what a dementia friendly community looks like and how we can all take steps to become more dementia friendly. An important start is for everyone in the community to become a Dementia Friend. Becoming a Dementia Friend is quick and easy

and shows your support for people living with dementia and their families. We can all make a difference.

'Dementia-Friendly community' Workshop

When: Wednesday 5 June, 11am-12noon.; **Cost:** free – morning tea provided; **Where:** Glebe Town Hall, 160 St Johns Rd

If you have enquiries, or would like to register to attend this session, please email DementiaFriendly@dementia.org.au or phone 02 8875 4667.

Pymont Cares

Pymont Cares collects furniture and white goods and gives these to people in need who are referred to us by case workers from a large range of agencies.

Pymont Cares collects only quality recycled furniture and whitegoods. Currently they particularly need chests of drawers; small sofas; small dining tables (2-4 seat). They do not collect: mattresses, beds, clothing, soft furnishings,

wardrobes, office furniture, or large three-person sofas. If you would like to arrange a pick-up, or get more information, see www.pymontcares.org.au/



Volunteers Richard and Marcus assembling a table before dispatch (image: Pymont Cares)

History & Heritage, continued

19 Avenue Rd – but wait, there's more! by Rodney Hammett

Further details of the families associated with 19 Avenue Rd have come to light since the original story about this home in the June 2018 issue of the [Bulletin \(no. 4 of 2018, p.9\)](#)



*Dr William Thomas Joseph Newton
(Source: Ancestry.com)*

No 19 was purchased as a vacant lot by builder Robert Coupland Winn in August 1896 from George Boyce Allen and was therefore the likely builder of the house before he sold it to twice-widowed Elizabeth Roff (née Lynch) of Glebe in May the following year.

Robert Winn built a number of houses in the Toxteth Estate in the 1890s and early 1900s, some of which are identified in the earlier

Bulletin issue referred to above which also has his biographical details.¹

Tragically Elizabeth, the landlady of the Great Britain Hotel² at the corner of Mitchell St and Campbell St in Glebe, died in July 1897 aged only 44 years, having owned No 19 for only two months. Eventually the property was transferred to her son Dr William Thomas Joseph Newton in 1903. There

were eight surviving children at the time of Elizabeth's death, all orphaned upon her death.

Dr William Thomas Joseph Newton was the eldest son of Elizabeth and Glebe hotelier Adam Newton. Dr Newton graduated from Sydney University in 1900³ and worked in country NSW for some years before he and his wife moved to live at Campsie and raise their four children. William had married nurse Ethel Margaret Neild on 27 January 1904 at the St Matthias Parish Church, Oxford St, Paddington. At age 42, Dr Newton enlisted for WW1 in May 1915, arriving in Egypt a month later where he was appointed major in the Field Ambulance Corps early in 1916. Posted to the Greek island of Lemnos he was part of the Australian medical team treating the wounded from the Gallipoli campaign. While there, William succumbed to tuberculosis and was eventually repatriated to Australia in December 1916, then discharged in March 1917.

William Newton took a keen interest in public affairs, being for six years an alderman of Canterbury Council and also a voluntary worker at Canterbury Hospital.

The Deane family (see details in June 2018 *Bulletin* article) were tenants at No 19 Avenue Rd from 1897 to 1906; following which John Thomas Cains and family lived there until 1912⁴. Dr Newton sold

the property in August 1909 to spinster Catherine Ellen Fitzpatrick of Glebe.

Interestingly, Catherine was listed as living at 19 Avenue Rd in the police report of a burglary of her jewellery and valuables from this dwelling in 1916⁵ although the Sands Directory has Mrs Margaret Clarke as the head of household in that year. Other details of Catherine's life have not yet been found.

In June 1924 Christina Coulson purchased No 19 from Catherine Fitzpatrick. Widowed in 1917, Christina, then 57, had a grown up family of two sons and two daughters with husband Henry (born 1855, Darlington, Durham, England). They had been living at *Barnscourt*, Lodge St, Glebe just near the Glebe Town Hall. The members of this Coulson family then lived at No 19 for 27 years.

Henry's cousin Harry Coulson (1860-1935), a patternmaker, lived nearby at 23 Boyce St with his wife Margaret (1870-1955) and daughter Ethel (1902-1998). The Coulsons were devoted Methodists.

In Durham, the Coulson family had been involved in iron-making. They brought their expertise to Sydney, establishing an iron foundry, working as patternmakers, working on the machinery at CSR's Pymont sugar factory and working for the railways.

At No. 19, eldest son Thomas Ralph Coulson (1885-1958) had, by 1908, travelled to Macknade, north of Townsville in Queensland where he worked as an engineer in the sugar mill. Following an industrial accident where he became partially blind, he married and became an orchardist in Terrigal. Thomas with wife Mary (née Edward) and two daughters returned to Glebe by 1934, initially living at 24 Eglinton Rd in one of the houses built by Mary's father Robert Buik Edward, a retired postmaster and property owner who purchased Nos 4-44 Eglinton Rd as vacant lots in 1908.⁶ They later lived at 34 Allen St. Some readers would remember Nan Coulson, a teacher, who was one of the daughters of Thomas and Mary, who lived at 34 Eglinton Rd for many years.

Son Henry Roy Coulson (1893-1950) lived with his mother at No 19 until 1941. He and wife Olive married in the Stanmore Methodist Church in March 1925 after purchasing No 19 from Christina in December 1924. Henry was a design engineer. His family moved to Neutral Bay in 1941 at about the time his sister Iris purchased No 19 from him in March of that year.

Daughter Christina Myra Coulson (1888-1959) married dentist Harold Rufus Carter in 1915. They lived at 6 Dickson St, Haberfield raising two daughters and a son. Tragically son Graham died aged only 22 in June 1945 and shortly thereafter daughter Valry died during childbirth in October 1945 after being married for only 18 months. Surviving daughter Norma Mary married Bernard Cole, a linesman, in 1946 and then lived at No 19 with Iris for some years before moving to Epping where they lived with Christina and Harold.

Daughter Iris Nerida (1891-1977) never married and lived at No 19 until late 1951 when she sold it to Daniel Minogue. Aged 60, Iris probably retired in 1951 living in her retirement for some time with her sister's family at Haberfield before moving to Epping.

Matriarch Christina died on 10 February 1945 aged 85. As a long and valued member of the Methodists in Glebe and Forest Lodge she was sorely missed and her passing was recorded fondly in *The Methodist* publication of March 1945:

Blessed with a vital personality, and endowed with mental and spiritual gifts of a high order, she laid all upon the altar in consecrated effort. She exercised a deeply religious influence in the lives of the women and girls of the circuit. Her remarkable gifts of organisation and leadership were such that it is not too much to say that for many years ... she was the rallying centre in all church activities.

The Minogue family lived at No 19 from 1951 until July 1979 when it was purchased by Robert and Heather Olup. Ownership changed, however, in August 1962 when Daniel's daughter Mary with her husband Patrick Grealish purchased the property from Daniel. Details of the colourful life of the Minogue family can be found in the June 2018 Bulletin.

Rodney Hammett

Notes: 1. See Glebe Society *Bulletin*, 2017 Issue 4 (June); 2. The Great Britain hotel at the corner of Mitchell and Campbell Streets was established in about 1874. It changed its name to the Courthouse Hotel in Sept 1899. The hotel ceased business in 1908 by order of the Licensing Court following a review of the number of licences in 14 of the State's electorates, a vote passed at the 1907 State Elections. See also *Daily Telegraph* of Fri 29 Nov 1907, p9 & *Daily Telegraph* of Thursday 12 Dec 1907, p10; 3. Australasian Medical Directories (1883-1915); Ancestry.com; 4. Sands Directories; 5. NSW Police Gazette, Ancestry.com; 6. See 24 Eglinton Rd in The Eglinton Rd Project.

Bulletin deadlines for July

Because of the Glebe Society Community Festival, the July *Bulletin* (no. 5 of 2019) will be delayed by one week. The copy deadline is now 3 July and the *Bulletin* will be published on 11 July.

100 Years Ago in Glebe & Forest Lodge – with Rodney Hammett

April 1919: Glebe Dirty Red, Alex Bolewski, returns from Lebanon

A GLEBE SOLDIER.

A. Bolewski, the Glebe player, who is returning from active service, writing to C. H. J. Upton from Tripoli, states he expects to be back in time to play in the serious games. He is training on board ship. Continuing, he writes: "I have taken part in eight games this season and will play again to-morrow (February 3) and perhaps another match a few days later. Rain interferes a good deal with

sport just now. I am in the 4th Field Ambulance team.

The Lebanon mountains are directly in the background. They are supposed to be 10,000 feet above sea level. At the present time they are covered with snow which is falling heavily this morning. Parties go up to the cedars now and again. I may do the trip before leaving. I was lucky to get Cairo leave from this place. We left here on Christmas Day and spent New Year's Day there. We missed the boat on the return journey and spent an extra week at Port Said rest camp.

The 4th Ambulance had sports last Monday. I got two firsts, one second and two thirds. I won the broad jump and sack race, and was second in the high jump. Four feet eight and a half inches was my best. I was third in the hop, step and jump and kicking the football longest distance, being beaten only by inches in this event.

Source: Referee; Wed 23 Apr 1919, p.9

Research Note: Alexander Bolewski (1892-1981) was the 4th of seven sons and a daughter of Polish immigrants Antoni and Helena. Alexander grew up in Lismore then Bundaberg. Alex and his brothers were talented sportsmen. Older brother, Michael, had been chosen for the first Australian rugby league team to tour England in 1908-09. Alex worked as a boilermaker in Sydney and played football for Glebe. Further details of his sporting exploits and experiences can be found in Max Solling's book *An Act of Bastardry. Rugby League Axes its first Club. Glebe District Rugby League Football Club 1908 to 1929*. Max interviewed Alex in 1980.

May 1919: Returning Soldiers

Amongst the 415 soldiers on the troopship *Plassy* returning on Saturday 3 May 1919 was James Rigby from Glebe.

Private J. Rigby, of the Glebe, who is just 18 years of age, was the first of the returned soldiers to step out of a motor car at the Buffet. His brother, who served three years, and who returned in February last, was at the Buffet to greet him. The "real war" which the boy soldier saw during 18 months' service at the front included Villers Bretonneux, Perrone, and Mt. St. Quentin. He was twice wounded.

Image: Sydney Morning Herald; Mon 5 May 1919, p.6

May 1919: Industries that called Glebe home

GENERAL ENGINEERS AND STEEL FOUNDERS.

Messrs. W. Hoskins & Sons, general engineers and steel founders, of Greek Street, Glebe, Sydney, have plant second to none, and are therefore in a position to turn out really first-class work. They are makers to the trade of motor car parts of any design or make, and repairs to any mechanical portion of the car can be undertaken. Castings of any design are made in brass, steel, cast-iron, gun-metal, aluminium, German silver, nickel, and phosphor bronze. Gear cutting is done on trade blanks. Case hardening and grinding is also carried out, and motor cylinders, crank-shafts, gears, and other parts are made to order. All repairs are machined ready to fit in place if required. A speciality is made of oxy-acetylene welding, and broken castings and machine parts of all kinds are welded equal to new. The firm are contractors to the N.S.W. Government. All work turned out has the personal supervision of Mr. Hoskins, and satisfaction to the trade is guaranteed. A trial will convince the most sceptical of the excellence of the work, and it will be found equal, if not better, than anything imported. Quotes on application or by ringing M1414.

Image: Daily Commercial News; Tuesday 27 May 1919, p.19.

May 1919: The Rainstorm

Glebe Point registered 453 points of rain in the 24 hours ending 9am Monday 5 May 1919. 453 points is approximately 115 mm. (Daily Telegraph; Tuesday 6 May 1919, p.6).

June 1919: The Trots



Source: Daily Telegraph; Friday 6 June 1919, p.6

Researcher's Note: Epping Trots became the Harold Park Trots in March 1929.

June 1919: Confectionery being manufactured in Forest Lodge



Source: Freeman's Journal; Thursday 5 June 1919, p.5

What's On

Thirsty Thursdays



Glebe Society members and friends are invited to meet in restaurants in and around Glebe, usually on the first Thursday of each month, to eat and talk with other people who live in Glebe.

We try to pick places where we can share dishes, and have eight or so people at each table. Put these details in your diary now:

➤ On Thursday 6 June at 7pm we will go to *Despaña*, 101 Glebe Point Rd. **Please note the change of venue.**

➤ On Thursday 4 July at 7pm we will go to *The Glebe Hotel*, 63 Bay St, Glebe, near Broadway (previously *Australian Youth Hotel*).

➤ And on Thursday 1 August at 7pm we will go to *Charleston*, 199 Glebe Point Rd.

Please email me at thirstythursday@glebesociety.org.au or ring me on 9660 7066 by 6pm on the Tuesday before to let me know if you are coming, or if you are likely to be late.

Edwina Doe

Players in the Pub

One-Act Comedies by Gordon Daviot

directed by Cassady Maddox

When: 7pm Wednesday 19 June 2019

Where: Toxteth Hotel 345 Glebe Point Rd, top floor (entry via Ferry Rd staircase)

Cost: Free admission (donations bucket)

Wednesday burger / tap beer / wine \$20 dinner special. Please order early, we always aim to start on time!



Gordon Daviot was a pen name of Elizabeth MacKintosh, best known as mystery novelist Josephine Tey (source: josephinetey.net)

Artisans Market Glebe: Winter Market 15 June 2019

Artisans Market Glebe will be held in Foley Park, on the corner of Bridge Road and Glebe Point Road Glebe, on Saturday 15 June 2019 from 10am to 3pm with more than 60 stallholders. All work is original and nothing is mass produced. Stalls range from fashion and ceramics to jewellery and homewares. One thing you can be certain of is that each piece has been handmade and is in its own way unique.

Now in its fourth year, this carefully curated market has a huge range of products to tempt you, with a selection of new stallholders at each market. As well as checking out the goods and talking to the stall holders, you can relax and listen to live music.

Held only every three months this is an opportunity not to be missed.

For more information go to
www.glebeartisansmarket.org.au or
facebook.com/artisansmarketglebe/



(source: Artisans Markets Glebe)

Learn more about John Verge, architect of Lyndhurst

Historian Ross Berry of *Tempe House* discusses John Verge (1782-1861) the most fashionable architect of Sydney's colonial period, specialising in Greek Revival and Regency style of architecture. Learn more about magnificent houses such as *Elizabeth Bay House*, *Camden Park*, *Tusculum* and *Lyndhurst*.

Hear also about a prefabricated house Verge designed in Sydney which today is one of the most famous houses in New Zealand.

When: 10.30am to 12 noon; 4 June

Where: History House, 133 Macquarie St, Sydney

Cost: \$20

A Brief History of the Glebe Art Show

The Glebe Society is very fortunate to have received the assistance of the Glebe Art Show in arranging the Glebe Society Community Festival.

According to the website of the Glebe Art Show, in 1993, there was strong community opposition to a NSW Government proposal to sell the site of the old Sydney Homoeopathic Hospital (the original 1870s building *Benledi*, on Glebe Point Rd) to the Department of Corrective Services for use as a women's transitional detention centre.

At around the same time, Leichhardt Council (which at the time included Glebe) had closed the old Glebe Library on Bridge Rd and was looking for a new site for the library.

For more information:

<https://hhaoa.wildapricot.org/event-3301621>



John Verge by James Armstrong Wilson (image: State Library of New South Wales)

GAUGE
GALLERY

GEORGE+JIRI

The first joint art exhibition of two
doubly-gifted jazz musicians
Opening night 6pm Tues 4 June | Until Sun 16 June 2019



George Washington
Violinist + Vocalist + Visual Artist

George is an internationally renowned Sydney jazz musician and visual artist. For the past 20 years George's art has revolved around light boxes and assemblages inspired by all things architectural and design.



Jiri Kripac
Trumpeter + Vocalist + Visual Artist

With beginnings in drawing, architectural drafting and painting, Jiri's practice has settled for 20 years now on sculpture made from pianos and found objects. His love for Vintage Jazz has earned him the title of "The Bouncin' Czech".

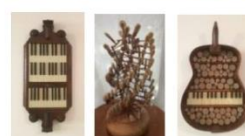

Gauge Gallery | 68 Glebe Point Road Glebe NSW 2037 | Sydney Australia | +61 2 9552 1552 | Open Tuesday to Saturday 10am-5pm | Sunday 1pm-5pm

In the face of community pressure, the NSW Government scrapped its proposal to sell *Benledi* to the Department of Corrective Services and agreed instead to sell it to Leichhardt Council for use as the new Glebe Library.

In 1994, Leichhardt Council set up a public fund to collect money for the purchase and development of *Benledi* as the new Glebe Library. Part of the community fundraising effort was a successful art show put together by local artists and held in St Johns Church Hall in April 1994.

In 1996 the new Glebe Library building and the renovation of *Benledi* were complete. A small show of paintings decorated the walls of *Benledi* as part of the grand opening celebrations.

The Glebe Chamber of Commerce, which had been instrumental in the campaign to repurpose the *Benledi* site as a library, then approached the organisers of the initial fundraising art show, local artists James Barker and Robin Lawrence, with the idea of holding an annual art show.

Thanks to the Chamber and to a supportive Leichhardt Council, the first Glebe Art Show was held in July 1997 at Glebe Library and in the adjoining *Benledi* building. The show continued to be held at the Library for 20 years. In 2003, a change in boundaries saw Sydney City Council take over the administration of Glebe from Leichhardt Council.

Sydney City Council has continued to support the Glebe Art Show. In 2018 the show moved to the Tramsheds.

Judy Vergison



Peter Griffen is Chairman of the Glebe Art Show (image: Laurence McManus)

Mystery photo, with Lyn Collingwood



Last month's mystery photo

Wendy Relf identified last month's mystery photo as 146-156 St Johns Rd, photographed here before it was restored as part of the Glebe Project.

This is the oldest terrace on the Glebe Estate; it dates from the 1840s.

This month's mystery photo

It's 1937. Where are we?

Please send your suggestions to history@glebesociety.org.au



Can you identify this mysterious bust?



One of our members has noticed this bust atop the roof of the property at 123B Mitchell St Glebe – on the corner of Mitchell and Derwent Sts.

The photos below, while not great, show some features of the bust in greater detail.

If you have any information about this interesting creature, please get in touch with Virginia:

editor@glebesociety.org.au

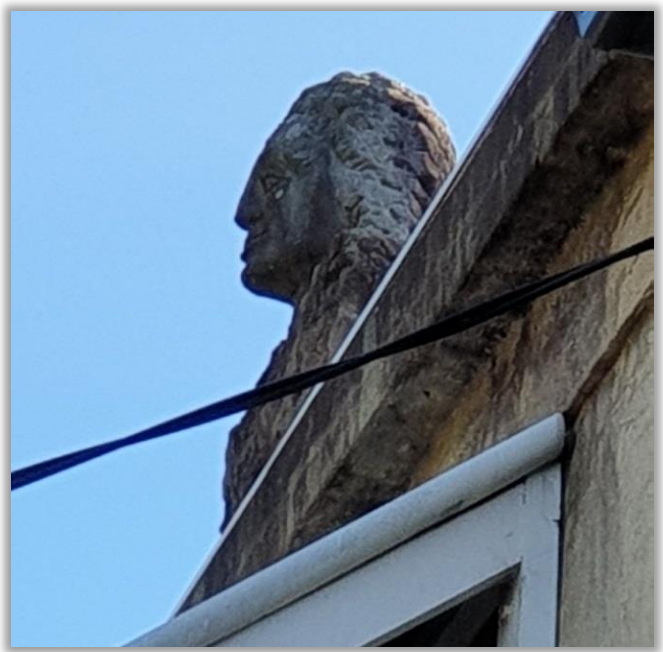

Who (or what) is this? And why is she/he sitting on a roof in Mitchell St Glebe? The bust appears to be made of stone – or is it concrete? What do the circular designs on the chest indicate? (images: V. Simpson-Young)

GLEBE SOCIETY COMMUNITY FESTIVAL
CELEBRATING 50 YEARS

23-30 June 2019, Harold Park Community Hall, Tramsheds, Forest Lodge
glebesociety.org.au/50th_anniversary_festival



For Your Calendar

Thursday 6 June, 7pm. *Thirsty Thursday @ Despaña* 101 Glebe Point Rd.
 Saturday 22 June. *Friends of Orphan School Creek Bushcare Group working bee* (contact Judy Christie 9660 8309).
 Sunday 23 June. *Glebe Society Community Festival Launch Party*, Tramsheds.
 Sunday 23 June to Sunday 30 June. *Glebe Society Community Festival*, Tramsheds.
 Monday 1 July, 6-8pm. *Festival Volunteers BIG Thank You Party!* Tramsheds.
 Thursday 6 July, 7pm. *Thirsty Thursday @The Glebe Hotel*, 63 Bay St, Glebe, near Broadway (previously *Australian Youth Hotel*).
 Sunday 25 August, 3-4.30pm. *Glebe Society 2019 Annual General Meeting*, Glebe Town Hall.
 1 to 24 November. *30th Annual Glebe Music Festival*, <http://www.glebemusicfestival.com/>
 Thursday 6 August, 7pm. *Thirsty Thursday @ Charleston*, 199 Glebe Point Road.



Last Wednesday of the month, 1-2.30pm. *Glebe Carers Support Group*, Glebe Town Hall.
 2nd & 4th Friday of the month, 10am-1pm. *Sewing 4 Good, Kitchen Starter Pack drop-off*, Aboriginal Space, Glebe Town Hall.

Glebe Society Inc. Established 1969

Management Committee

President	Verity Firth		president@glebesociety.org.au
Vice President	Diane Hutchinson	0407 207 177	vicepresident@glebesociety.org.au
Past President	Allan Hogan	0411 607 813	pastpresident@glebesociety.org.au
Secretary	Jude Paul	0438 600 882	secretary@glebesociety.org.au
Minutes Secretary	Mark Stapleton	0417 238 158	minutes@glebesociety.org.au
Treasurer	Jane Gatwood	0488 118 355	treasurer@glebesociety.org.au
Ordinary member	Dorothy Davis	0417 240 603	dorothy@glebesociety.org.au
Ordinary member	Mark Gorta	02 9660 6613	mark@glebesociety.org.au
Ordinary member	Mark Stapleton	0417 238 158	minutes@glebesociety.org.au
Ordinary member	Janet Wahlquist		janet@glebesociety.org.au
Bays & Foreshores	Lesley Lynch	02 9660 5084	bays@glebesociety.org.au
Blue Wrens	Andrew Wood	02 9660 6104	bluwrens@glebesociety.org.au
Communications	Virginia Simpson-Young	0402 153 074	communications@glebesociety.org.au
Community	Janice Challinor	0401 505 657	community@glebesociety.org.au
Environment	Asa Wahlquist	02 9660 8261	environment@glebesociety.org.au
Heritage	Brian Fuller	0409 035 418	heritage@glebesociety.org.au
Planning	Neil Macindoe	02 9660 0208	planning@glebesociety.org.au
Transport & Traffic	Janet Wahlquist		transport@glebesociety.org.au

Working Groups & Contacts

Glebe Island Bridge	vacant		transport@glebesociety.org.au
Archivist	Lyn Milton	02 9660 7930	milton.lyn@gmail.com
<i>Bulletin</i> Editor	Virginia Simpson-Young	0402 153 074	editor@glebesociety.org.au
Events	Judy Vergison	0417 446 425	events@glebesociety.org.au
Local History	Lyn Collingwood	02 9660 5817	history@glebesociety.org.au
History of Glebe	Max Solling	02 9660 1160	
Glebe Voices	Fiona Campbell	02 9660 0185	glebevoices@glebesociety.org.au
Thirsty Thursdays	Edwina Doe	02 9660 7066	thirstythursdays@glebesociety.org.au
Web content	Flavia Morello		webmaster@glebesociety.org.au
Website technical	Peter Thorogood	0404 801 947	support@glebesociety.org.au
Facebook	Virginia Simpson-Young	0402 153 074	facebook@glebesociety.org.au
Twitterer			twitter@glebesociety.org.au

Highlights this Issue

COUNTDOWN TO THE COMMUNITY FESTIVAL – JUST THREE WEEKS TO GO!	1
LETTERS TO THE EDITOR; REPORT ON 'MEET THE CANDIDATES' FOR THE FEDERAL ELECTION	2
PLANNING REPORT	3
GPR IN 1991 AND NOW – AT THE GLIDE OF YOUR MOUSE! PARK AND PLAYGROUND UPGRADES BY THE CITY OF SYDNEY	4
BELLEVUE DECISION	5
AVONA AVENUE, BY RODNEY HAMMETT	6
NEWS FROM THE BLUE WREN SUBCOMMITTEE	8
CAN GLEBE BECOME A 'DEMENTIA-FRIENDLY COMMUNITY'?	9
19 AVENUE RD – BUT WAIT, THERE'S MORE! BY RODNEY HAMMETT	10
100 YEARS AGO IN GLEBE & FOREST LODGE – WITH RODNEY HAMMETT	12
THIRSTY THURSDAYS ;PLAYERS IN THE PUB; ARTISANS MARKET GLEBE: WINTER MARKET 15 JUNE 2019	13
LEARN MORE ABOUT JOHN VERGE, ARCHITECT OF LYNDHURST; A BRIEF HISTORY OF THE GLEBE ART SHOW	14
MYSTERY PHOTO, WITH LYN COLLINGWOOD	15
CAN YOU IDENTIFY THIS MYSTERIOUS BUST?	16



PO Box 100 GLEBE NSW 2037

No 4 of 2019 (June 2019)

Membership of the Glebe Society

- Individual member: \$45
- Joint (2 people, one address): \$55
- Household: \$60
- Concession (student or pensioner): \$20
- Institution or corporate: \$110

How to join

- Join online: complete the Membership Application on our website under 'Membership'
- Download a membership form from www.glebesociety.org.au; or
- Write to the Secretary at PO Box 100 Glebe 2037; or
Email secretary@glebesociety.org.au



'Meet the Candidates' Federal election event at Glebe Town Hall on 4 May (image: V. Simpson-Young)

Views expressed in this *Bulletin* are not necessarily those of the Glebe Society Inc. Articles and photos submitted for any of the Glebe Society's publications, including the website and *Bulletin*, may also be used in the Glebe Society's other publications.