



Gardening Australia films in Glebe

By Jan Macindoe

Costa Georgiadis, host of ABC TV program 'Gardening Australia', and a film crew visited Glebe on 19 October. St Helen's Community Garden and the kerb garden of Jock Keene in Toxteth Rd were the subjects.

Community garden members who were available in the middle of the day gathered in the garden and did their best to look like they were behaving normally. Jock, one of the garden coordinators, was the main interviewee and experienced the many 'takes' that are a normal part of filming even a short segment.

All community garden members were delighted that our garden was receiving this attention. There are currently 80 members of the garden, including about 10 children. Up to 20 members meet on Sunday mornings from 9-11am, as well as on Thursday evenings 5-6pm during daylight saving time.

As well as enjoying the healthy outdoor activity and fresh produce, members enjoy the social contact and the chance to learn gardening skills from each other. The garden also contributes to waste management in the local community by

using up to 30kg of vegetable waste from local business and residents per week, through composting and worm-farming.

We understand that the segment will be screened in a Gardening Australia episode early next year.

Jan Macindoe



Jock Keene talks with Gardening Australia's Costa Georgiadis and crew member (image: Jan Macindoe)

Planning & Infrastructure

WestConnex: Communities Show their Distaste for a Bad Project

Submissions on the Environmental Impact Statement for the M4-M5 Link closed on 16 October.

The Department of Planning and Environment has received a huge number of submissions opposing the project, including 10,450 hard copy submissions from across the Inner West and City of Sydney Council areas.

The Glebe Society, Forest Lodge Public School P&C, Stop WestConnex – Glebe Forest Lodge and COGG all lodged submissions. The Glebe

Society's submission has been put on our web page under Local Issues, Transport and Traffic.

(continued next page)

**Last chance to register for this
Glebe Society event ...**

**How to Research Your
House History Online**
(details p.11)

(continued from p.1)

This is a powerful message to the NSW Government that people are unhappy about WestConnex and the havoc it is inflicting on communities for no obvious gain. The Department will now seek responses on the submissions with the Minister then deciding whether to approve the M4-M5 Link. There is unlikely to be any decision from the Minister before March 2018.

WestConnex is a State Significant Infrastructure project. This means that a series of steps will be taken before a decision is made. The Department will send the submissions to the Sydney Motorway Corporation (the owners of WestConnex) and to other government agencies for their response. Once responses are received, the Department will prepare an assessment report for the Minister taking into account the submissions, the responses to the submissions

and reports and advice from other public authorities. The Minister will then consider the Department's assessment report and decide whether to approve the project.

Even if the Minister approves the project, there are significant hurdles facing the project. A key issue is whether the Government is able to find a buyer for WestConnex. The State Government is intending to sell 51% of the shares in the Sydney Motorway Corporation along with the toll revenue generated by WestConnex. The sale is meant to fund the cost of building the M4-M5 Link. Given the failure of other toll road projects, including the Cross City Tunnel and the Lane Cove Tunnel in Sydney, there is no certainty that a buyer will be found. If a buyer can't be found on terms suitable to the State Government it seems unlikely the M4-M5 Link, along with the Rozelle Interchange, will ever be built.

Murray Jewell



(image: <http://www.westconnex.info/>)

Planning Report, by Neil Macindoe

Three CBDs?

In the last *Bulletin* of 2016 I reported on a Parliament House Conference hosted by the Better Planning Network where the Greater Sydney Commission released its initial plans. Now they have hit the headlines (*SMH* Monday, October 23) with its release of the draft Future Transport Strategy. The key promise is that with the division of Sydney into three hubs, the Western Parkland City based on Badgerys Creek Airport, the Central River City based on Parramatta, and the Eastern Harbour City based on the current CBD, by 2056, with a population of eight million, most people will enjoy a thirty minute commute.

Most of us will be dead, of course, but if you are lucky enough to still be alive you should be able to enjoy the expanded public transport network which the proposal requires. Any decentralisation requires vastly improved public transport, along with major increases in infrastructure, which have not yet been announced. Of course, there continues to be a tension between relatively quick fix and bandaid solutions, to which governments are unfortunately addicted, and longer term, genuine decentralisation. The NBN was also supposed to ease decentralisation, before the original plan was torpedoed. We will no doubt see other proposals to aid decentralisation, such as high speed rail, which has the advantage of locating

population increase outside the existing Greater Sydney area.

Just to remind you, other parts of the State have absorbed much of Sydney's population increase in the past, such as the North and Central Coasts, and there is still a substantial drift to other regions and other states. However, we must expect Sydney to continue to exert considerable magnetism, particularly for jobs and culture, so debate about the number of new residents Sydney can absorb will continue.

147-9 Glebe Point Road (former Sushi Garden)

So far as I'm aware, this is the only wooden building surviving in Glebe Point Road, and the only wooden shop in Glebe. Normally this would ensure its retention, but unfortunately it is much altered, and what remains does not have a strong connection to the original mid-Victorian buildings, probably two small houses under one roof. However, there is a case for retaining elements of the late Victorian facade, such as the splayed doorway, iron columns and associated windows, and certainly for recording the building comprehensively and attaching an

interpretative plaque. The Society shall respond to the current commercial/residential DA along these lines.

Neil Macindoe
Convenor, Planning



147-149 Glebe Point Rd, former Sushi Garden – possibly the only wooden shop in Glebe. (image: V. Simpson-Young)

History & Heritage

Who lived in these houses? by Rodney Hammett. Northcote Rd – the first owners and occupants



Source: <http://maps.six.nsw.gov.au/>

Northcote Rd was part of the final subdivision of the Toxteth Estate, advertised for sale in October 1904.

Federal Park (Glebe) was then much smaller, bounded by Eglinton Rd and Victoria Rd (to the south), Northcote Rd (to the east), what is now the pathway to the bridge from Federal Rd (to the north), and the canal (to the west). The Annandale part of the park was west of the canal.

The pathway was originally a road (Federal Rd) constructed in 1899¹ after the reclamation works which now form the Bicentennial Park but then they were for waterfront use managed by the Harbour Trust Commission.

Creation of the park began in 1901.

*'Mr. J. A. Hogue, M.L.A. for the Glebe, and Mr. W. H. Mahoney, M.L.A. for Annandale, have been informed that the sum of £50 has been set apart by the Minister for Lands for the improvement of Federal Park; also, that the services of a landscape gardener will be placed at the disposal of the trustees of the park for the purposes of laying out the ground.'*²

One of the earliest recorded sporting uses of Federal Park was a cricket match in 1902 involving aldermen³.

The park had become very popular and reportedly 'thousands of people were using it' as documented by the Annandale and Glebe Councils in their appeal for more funds from the State Government in 1905.⁴

Despite the local support for its inclusion into the park the waterfront continued to be used by waterfront industries right up until 1988 when the Bicentennial Park was created.

Tree planting at Federal Park '...was commenced on Saturday afternoon, [24 October 1908] when at the invitation of Glebe Council a number of residents of Glebe and Annandale assembled to witness the ceremony of planting the first 12 trees along the western boundary of the park.'⁵

Sales

The first lot to be sold was No11 in January 1905 although it wasn't until 1923 there were house numbers. Prior to then each house was named and No11 was "Lorne".

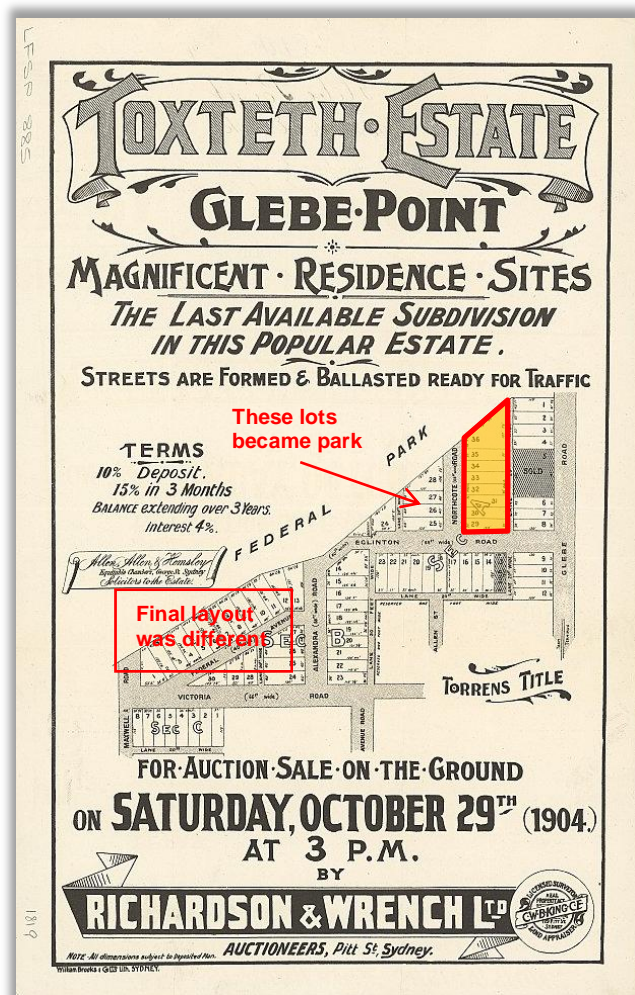

(image: National Library of Australia [map-lfsp885])

Sisters **Irene and Leila Oatley** were the owners and living with their father William, the head of the household in the 1908 Sands Directory the first time Northcote Rd was included.

William Oatley (29) had married Amelia Graham (25) on 18 August 1881 in Sydney however it was a troubled union. Living in Leichhardt, Amelia ran off with a neighbour leading to their

divorce in 1899⁶ but all must have been forgiven over time because they remarried in 1917⁷.

William was a clerk in the Department of Public Works NSW, joining in January 1873 aged 20⁸. When he retired in 1915 aged 63 and after 42 years' service he was earning only £260 pa, very little more than the £250 pa he got in 1898.

Irene (30) was the first to marry, to George Hewitt (35) in 1912, soon after his divorce from his first wife⁹, and not long before Irene's first child Alma was born. They moved to 10 Arthur St, Forest Lodge overlooking Minogue Crescent and the trotting track at Harold Park where they had two sons and a daughter before George died in 1925. Irene died in 1961 at Newtown aged 79.

Leila (36) married Louis Charles Willis, an upholsterer, in 1920. They lived in Darlinghurst first at 322 Victoria St then at 8 Royston St until Louis died in 1952. Leila then went to live with Irene at Forest Lodge. She died in 1963, also aged 79.

Irene and Leila sold No.11 in February 1909 to Johanna Freeman of Glebe Point, a married woman.

Jessie Hogg purchased No 5 (Bonnie Doon) in December 1905. Her husband, Sergeant James Hogg of the NSW Police, joined the police force in 1883 aged 26, reportedly a year after arriving from Scotland on the ship Duntroon¹⁰.

Jessie had arrived in Sydney travelling 3rd class from London on the steam ship Oroya on Friday 19 August 1887, the then fastest ever recorded voyage between the Suez Canal and Adelaide and only 41 days from Plymouth¹¹. They married in 1889 having two daughters (Mary A b1890, Jessie B b1892) and a son (James E b1898).

Initially living at 63 Rose St, Chippendale, then 38 Broughton St, Glebe the family moved into their new home at No 5 Northcote Rd in about 1907. Hogg family members continuously owned No 5 until 1972.

Senior Sergeant James Hogg, as he became, fearlessly prosecuted the law and was particularly disliked by some Glebe residents when he was in the Licensing Branch¹². He died in 1935 aged 78.

Jessie continued to live at No 5 until just before her death in January 1952 at which time, aged 92, she was living with her daughter Mary MacKenzie at Homebush.

Architect/builder **Henry Beeson** purchased No.15 in April 1906. Henry had already built a

number of other houses in Glebe and at this time was living at Turramurra¹³. It is likely he built all the houses in Northcote Rd but as yet there is no definitive evidence.

Henry sold No.15 (*Wybenia*) in March 1907 to Hester Augusta Norris, wife of Charles Robert Norris of Thursday Island, postmaster. See discussion below.

Emilie Williams, wife of Henry G Williams letter sorter, purchased No.17 (St Malo) in April 1906.

Emilie, daughter of a French master mariner, Emile Landergren was born in Brittany, France. It is at present unclear when she arrived in Australia but she and Henry married in Sydney in 1897 and had two sons before moving to No.17. They were Harry b1900 and Jack b1903.

How Emilie and Henry could afford to purchase the property on Henry's salary of £150 pa¹⁴ is worthy of further investigation.

Harry died in 1924. Emilie, Harry jnr and Jack continued living at No.17 while the boys completed their education, eventually both becoming accountants.

The three of them moved to 2 Orinoco St, Pymble in 1937 however No.17 wasn't sold until January 1940. Emilie died on 25 May 1949 leaving the boys the Pymble property.

Harry (49) married Mona Gwydir (45) in 1949. The couple enjoyed over 30 years of marriage in Pymble until Mona died in 1982 and Harry in 1984.

Jack's whereabouts after the 1954 Electoral Rolls are not known.

Mary Ann Theresa Kelly (1861-1946) wife of Augustine James Kelly, farmer in the Hawkesbury Valley purchased No.7 (Hillside) in June 1906 with a mortgage from Reginald Charles Allen and Arthur Wigram Allen, solicitors.

The property was sold in June 1908 to Ella M Green, most likely just after the house had been built.

Amy Annie McEnnally wife of William Charles McEnnally, fruit merchant, purchased No.9 (Gowan Brae) in October 1906.

Amy Viquert and William McEnnally were married at St Johns Church, Glebe on 31 October 1900, she was the 7th daughter and he the eldest son. Prior to moving into their new house the family had been living at 73 Westmoreland St, Glebe where they had two

children, then another three while at Northcote Rd.

The family moved to Manly in 1915, however they didn't sell No.9 until August 1928.

In addition to being a fruit merchant William had a timber case making business employing 20 men at Darling Harbour making packing cases for transporting fruit¹⁵.

In 1913 McEnnally Bros and Co Ltd was registered with a capital of £20,000 in shares of £1 each, for a tug boat business with the first directors William Charles McEnnally, Robert Morrow McEnnally and Edward A Lamb.

William must have been exploring possible business opportunities in New Guinea when he departed Sydney on the steamer Matunga on 27 July 1917, during WW1. Initially the ship was reported overdue with the list of passengers and crew published in the newspapers¹⁶. He and the other 19 passengers and 45 crew would have had no idea that their journey as prisoners-of-war would take them more than 20 months via Germany and England¹⁷.

Houses and First Owners

House No	Purchased	Purchaser
1	10 Sep 1908	Mary Kelleher wife of A W Kelleher, marine engineer
3	1 Jul 1908	Hester Augusta Norris, wife of C R Norris of Thursday Island, postmaster
5	4 Dec 1905	Jessie Grace Hogg wife of J Hogg, sergeant of police
7	14 Jun 1906	Mary Ann Theresa Kelly wife of A J Kelly, farmer
9	27 Oct 1906	Amy Annie McEnnally wife of W C McEnnally, fruit merchant
11	17 Jan 1905	Irene Alice Oatley and Leila Millicent Blanche Oatley, spinsters
13	20 Dec 1907	Russell Woodfield, master mariner and Isabella E Woodfield his wife
15	9 Apr 1906	Henry Beeson of Turramurra, builder
17	9 Apr 1906	Emilie Williams wife of H G Williams, letter sorter

(Source: *Certificates of Title*)

Eventually back in Australia he continued to work in the family business and also worked tirelessly for the returned WW1 soldiers and widows¹⁸ however William's wartime experiences must have played on his mind. He became a troubled man and in his last years he was an inmate of Broughton Hall at Callan Park Mental Hospital in the early 1930s. He died there in 1935 aged 61. Amy died in 1943 aged 67.

Master mariner **Russell Woodfield** and his wife **Isabella Elizabeth** purchased No.13 (Gunya) on 20 Dec 1907. Isabella's sister **Mary Kelleher** purchased No.1 (Trimden) on 10 Sep 1908.

Isabella Short had married English born Russell in 1900. No.13 was transferred to Isabella's sister Rose Crammond, victualler of Newcastle, in February 1912. By this stage Russell was gravely ill them both living with Rose's family in Newcastle.

No.13 was transferred back to Isabella's name in January 1913 and Russell died in November the same year, aged only 44. The property was sold in September 1920. Isabella died in January 1927 while on a trip to England, aged 56. They didn't have any children.

Mary Short had married marine engineer Albert W Kelleher in 1899 at about the time she purchased 12 Allen St, Glebe. The couple lived in Allen St for 16 years until she died in 1916, aged 51. After Mary's death Albert moved to Dulwich Hill where he died in December 1930, aged 77. It seems they didn't have any children.

On Mary's death No.1 was willed to her sisters Rose Crammond, Isabella Woodfield and Laura Kerr in November 1917. No.1 was sold by the sisters in August 1921.

Hester Augusta Norris purchased No.3 (Charliern) in July 1908. Readers would recall that Hester had already bought No.15 from Henry Beeson in March 1907 so No 3 was her second property in Northcote Rd. Both were investment properties.

Hester and husband Charles were English born however they married in Queensland in 1890. It would appear that they didn't have any children.

In 1907, Charles was the postmaster at Thursday Island in the Torres Strait. Later in that year he was promoted to become the postmaster at Mount Morgan, Queensland on a salary of £310¹⁹.

In 1911 Charles was appointed Federal Electoral Registrar to keep the roll for the Mackay subdivision of Herbert, in Queensland²⁰.

Charles later became the Registrar of the Supreme Court of Queensland, from which he retired in October 1924 at the retirement age of 65²¹. In retirement Charles and Hester enjoyed many trips back to England, some via the Suez Canal and others via Canada and New York, the last one being in 1938.

Returning to Sydney, the couple initially lived in Darlinghurst then at Double Bay. Hester died there in 1943 aged 81. Charles died in 1948 aged 89.



Both No.3 and No.15 were sold to Michael Toohey, victualler, in July 1918 to become part of his expanding property interests. The Toohey family also purchased No 11 in 1936.

11 Northcote Rd today
(image: realestate.com.au)

Rodney Hammett

Sources: ¹ *Daily Telegraph*; Mon 18 Dec 1899, p2; ² *Evening News* (Sydney); Mon 11 Feb 1901; p4 – Federal Park; ³ *Evening News* (Sydney); Fri 31 Jan 1902 – Aldermen at Cricket; ⁴ *SMH*; Fri 30 Jun 1905, p4; ⁵ *SMH*; Mon 26 Oct 1908, p5 – Federal Park; ⁶ *Evening News*, 26 Aug 1899, p6; ⁷ NSW Marriage Ref 6756/1917; ⁸ Ancestry.com; New South Wales, Australia, Public Service Lists, 1858-1960; ⁹ *SMH*, Sat 9 Nov 1912, p10; ¹⁰ *SMH*; 18 Jan 1935, p8 [Obit]; ¹¹ *SMH*; Sat 20 Aug 1887 [Arrival of the RMS Oroya] & Ancestry.com; Victoria, Australia, Assisted and Unassisted Passenger Lists, 1839–1923, Series: VPRS 7666; Series Title: Inward Overseas Passenger Lists (British Ports) [Microfiche Copy of VPRS 947]; ¹² Further details of Sergeant Hogg can be found in *Grandeur and Grit* by Max Solling; ¹³ See also Henry Beeson in 'Who lived in these houses? – Arcadia Rd (north side), by Rodney Hammett, Glebe Society *Bulletin* No 4 (June) 2017; ¹⁴ Ancestry.com; New South Wales, Australia, Public Service Lists, 1858-1960; ¹⁵ *SMH*; 7 Feb 1908, p7 [Enough to Frighten Anyone]; ¹⁶ *SMH*; 15 Aug 1917, p9 [Matunga Overdue] & *Townsville Daily*; 15 Aug 1917, p4 [Still no Tidings]; ¹⁷ See also State Library of NSW <http://acms.sl.nsw.gov.au/transcript/2013/D04594/a3040.htm>; ¹⁸ *Sunday Times*; Sun 30 Mar 1919, p2 [Manly's Thirteenth Soldier's Cottage]; ¹⁹ *Telegraph*, Brisbane; Tue 2 Jun 1908, p7; ²⁰ *Daily Mercury*, Mackay; Sat 12 Aug 1911, p6; ²¹ *Daily Mercury*, Mackay; Wed 1 Oct 1924, p6

Exhibition - Our City: 175 Years in 175 Objects

This social history exhibition in the lower town hall of Sydney Town Hall brings together for the first time the civic and archive collections, and demonstrates the council's role in building, inspiring, governing and leading the city over 175 years. These stories are told with 175 key objects and items, and supported by over 200 other images, documents, objects, oral histories, film and plans.

When? 27 October to 12 November

Where? Lower town hall, Sydney Town Hall; 11am to 4pm daily (late night Thursdays until 7pm)

Cost? Free

More information:

<https://whatson.cityofsydney.nsw.gov.au/events/our-city-175-years-in-175-objects>



This photograph, from 1977, shows the purpose-built room constructed in Town Hall House to house the council's mainframe computer. (image: City of Sydney Archives)

Who lived in your street? by Lyn Collingwood: George Bowen (1892-1917)

George Lloyd Bowen was a casualty of the First World War, but died back in Australia while the conflict was still raging far from home. At the time of his enlistment he was his widowed mother's only child, living with her at 277 Glebe Point Rd, in *Palmerston Terrace*. George's mother was a dressmaker and at different times called herself Mabel, Mary and Susannah.

Born Roman Catholic at Richmond NSW to John Ector Bowen and Susanna née Tierney (1855–1939) who married at Ryde in 1883, George was predeceased by two siblings: Lancelot Lloyd (who died aged 7 months in 1884) and Blanch Tydvil (who died aged 7 months in 1890). His father (who was a Mason) died aged 37 in 1892 and his six-year-old sister Marion Tydvil the next year.

George was educated at Fort St Boys. He made some pocket money winning prizes for items published in *The Arrow's* Brain Busters' column:

Q. What is the biggest gun in the service?

A. Don't know, but the Earth is the biggest revolver.

A customs clerk, George enlisted (service number 2880) on 1 March 1915 and was sent with the 5th Field Ambulance to Egypt, thence Lemnos and Gallipoli, where he landed on 23 August 1915. In October he was evacuated with typhoid and malaria (enteric fever) to the Australian General Hospital on Heliopolis, after

which he was repatriated to Australia, arriving on 3 January 1916. Discharged from the army on 9 August, he died in the 4th Australian General Military Hospital at Randwick on 26 May 1917 with his mother present. 'George L Bowen 5th F A B' was buried in Waverley Cemetery. Friends paid for his headstone.

Although the medical review board at Port Said in December 1915 accepted that George's enteric fever had been contracted at Gallipoli as a result of his military service, his claim for a disability pension was rejected in September 1916 on the grounds that he was not incapacitated. Posthumously he was issued all three World War One service medals in 1921, and in 1924 Deputy Commissioner of Repatriation J E Barrett finally accepted that his death was attributable to his war service and a Memorial Plaque and Scroll was issued to his mother.

Susannah Bowen remained at 277 Glebe Point Rd until the Depression when she moved to 144A St Johns Rd and then to 12 Hereford St and to 1 Toxteth Rd. 'Sorrowing' and 'lonely', she inserted regular memorial notices to her son in the *Herald's* On Active Service column:

*The will of Heaven my will shall be
His soul to Him who gave it rose
God led it to its own repose.*

Testate, she died on 16 August 1939. Her funeral service was held at St James Church Forest Lodge. George Bowen's khaki woollen private's cap is in the Australian War Memorial collection.

Lyn Collingwood
Historian

Sources: *The Arrow* 6.5.1911, 12.8.1911; NSW births, deaths, marriages registry; NSW cemetery records; NSW electoral rolls; Rod Holtham; Sands *Directories*; *Sydney Morning Herald* 7.7.1892, 28.5.1917, 25.5.1918, 29.5.1923, 27.5.1929, 27.10.1939.



George Bowen's Hat, now at the Australian War Memorial (Source: Australian War Memorial)

Community Matters

Community Notes, by Janice Challinor

Sunset Soirée for Centipede

There was a full house for our annual fundraiser for Centipede at Glebe Public School this year. Through the generosity of the Glebe Rowing Club we were again able to hold it at their premises overlooking Blackwattle Bay; a beautiful spot from which to enjoy the reflections of the setting sun as it lights up the towers of glass and steel which make up our city. Ridz outdid his catering offerings from last year by providing a range of tasty canapés throughout the event, while Jane served liquid libations to all comers. The festivities were enhanced by cheerful music played by Daniel and Michael from Edama Ruah while we judged the Centipede children's contest, and the fun of a game run by Centipede mum Rachel.

However the highlight for most was the presence of and reflections on community made by Leigh Sales, ABC's 7.30 anchor. Her references to the impact of technology on the ways in which communities form and interact was further evidence, if needed, of how our lives are changing. But the one constant here in Glebe is the ongoing support and interaction between Glebites that enhances all our lives. It was therefore with some disappointment that we learned Leigh was on the verge of moving to Camperdown. We thank her for supporting Centipede this year by her presence.

We were further honoured by the presence of some very busy local representatives at all three levels of government. Hon Tanya Plibersek, our federal representative spoke of the cohesion she has found in this part of her electorate; something also reflected by the presence of Jamie Parker MP, our state representative, and

Cr Jess Scully, City of Sydney councillor who lives locally. I wondered how many guests took the opportunity to lobby for their views to be heard in these fora. Ted McKeown, past president of TGSi took the opportunity to publically farewell much respected retiring principal of GPS, Vicky Pogulis; sentiments echoed by both Leigh Sales and Tanya Plibersek.



Local member, Tanya Plibersek, addresses the gathered crowd at the Sunset Soiree for Centipede. (image: Phil Young)

Then there was the giant raffle, for which some of the lucky winners were Glebe Society members Phil Young, Melinda Smith, Sue Hearn and Ros Diffey. It was the auction though which raised the greatest level of excitement. The original oil painting, 'Saturday Morning Glebe' by John Merlino, generously donated by Edwina Doe who has enjoyed it on her wall since it was shown at the second Glebe Art show 1989, went to Centipede mum Cate Stewart. Two signed and framed limited edition prints by internationally renowned local botanical artist

Angela Lober, donated by TGSi vice president Diane Hutchinson were strongly contested and eventually claimed by Jane Gatwood and Lesley Lynch respectively. John Barrer secured the dozen mixed wines kindly donated by Tim Smith of Glebe Liquor while the mounted photograph of the Glebe Waterfront donated by Phil Young will now adorn Jess Scully's walls. Finally the two Couples Bath House Experience packages were knocked down to Verity Firth and Bill Simpson Young. It should be noted that there were a few moments of palpable frisson when it was mistakenly assumed they were to share one package! Calm was restored when the realization that there were indeed two packages became evident. It is noteworthy that the auction alone raised \$3490 to help support Centipede's good work.

Our sympathy goes to Neil Macindoe who wasn't then present, a criterion to claim the door prize, a dinner voucher donated by our constant supporter, the Boathouse restaurant, but I'm sure Bill Simpson Young will enjoy it just as much. So the occasion went well, despite the absence of four Friends of Centipede who had serious unexpected matters to deal with that day. It is therefore with my sincere gratitude to Yolande Nardi, Bill and Virginia Simpson Young, Ted and Alison McKeown, Murray Jewell and Lorel Adams who stepped into the breach, and Jane Librieu, our stand-in auctioneer that it proved a successful event. Thank you Glebe Society members for your ongoing support of this annual event.

Christmas Gifts for Glebe's temporary residents

Following the recent tradition of welcoming strangers to our place at Christmas I am again appealing to the compassion and generosity of Glebe Society members in preparation for Christmas 2017. There are families and

individuals who reside temporarily in Glebe while overcoming difficulties life has thrown into their paths. This year the community committee of TGSi would like to be able to take gifts for residents to Elsie Women's refuge and to one or two other residential facilities, should there be sufficient response to do so.

As changes in occupancy occur at irregular intervals it is still too early to identify the age and gender of children at this time, however this information will be published in the December *Bulletin* and through a President's update in December. We are also planning to have a collection box at the Glebe Society Christmas Party where members will be able to gift small new personal hygiene items for both women and men, and non-age specific children's toys, clothes or books.

We have been asked to ensure no gifts are wrapped because they need to be checked for safety and security reasons before being distributed. The agencies will wrap them instead.

If you would like to provide a gift or two for some of these family members please contact Janice Challinor by phone, 0401 505 657, or email community@glebesociety.org.au to indicate what age group you have in mind, or to receive a suggestion of what's needed. I will collect gifts throughout December and deliver them on Friday 22 December.



(image: pixabay)

Janice Challinor
Convenor, Community

Vicki Pogulis' Retirement Party

Bryce Walker, Vice Principal at Glebe Public School, has invited interested Glebe Society members to a party to acknowledge and celebrate Vicki's 45 years of service to public education.

Where? 16 Eveleigh St Redfern

When? Saturday 9 December 7pm.

Cost: \$40 per person, which includes supper and cake. There is a cash bar at the venue.

Booking: www.trybooking.com/330257; this is a ticketed event and the booking system will open

on Tuesday, 31st October. RSVP: Friday 24 November.

Further information: bryce.walker@det.nsw.edu.au



Vicki Pogulis, Principal of Glebe Public School, who is retiring at the end of this year (image: supplied by Bryce Walker)



Creative & Connected

Glebe Society Event

The Glebe Society Christmas Gathering

Join us at the Glebe Town Hall in the elegant main hall for our Twilight Christmas Gathering on Sunday 3 December (5.30–8pm). This wonderfully restored building was built in 1880 and is a beautiful example of the Victorian free classical style with its elegant rooms.

Our theme is 'Just a Taste', where you will enjoy a delicious range of Indigenous food from 'Fred's Bush Tucker'. There will also be a selection of gourmet savoury finger food and sweet treats, all served with bubbly, wines, beers and a non-alcoholic fruit punch.



Gumaroy Newman (image: Gumaroy.com)
culture.

In the first hour you will be welcomed by music of Gumaroy (Roy Newman), an indigenous entertainer and cultural educator. Gumaroy is a proud Aboriginal man from the Gamilaroi and Wakka Wakka nations, who is passionate about sharing his culture.

About Fred's Bush Tucker

Fred incorporates the fantastic flavours from native herbs and spices into his range of Indigenous inspired catering. He offers quality, authentic Australian Indigenous bush foods and culture.



(images:
<http://www.fredsbushtucker.com.au/>)

Fred is committed to providing a sustainable product that promotes a healthy lifestyle as well as encouraging all to have 'Just a Taste' of what indigenous food has to offer.

You may have enjoyed Fred's Bush Tucker at the Blak Markets at Bare Island, where he is regular.

His catering service is recognised as a 'Supply Nation', endorsed by the Australian Government as the leading directory of Indigenous businesses.



When? Sunday 3 December, 5:30pm-8pm

Where? Glebe Town Hall (main hall, upstairs)

Cost: Tickets are \$55 per person.

Bookings: Bookings are essential and close on Thursday 30 November. You can book online at <https://www.eventbrite.com.au/e/christmas-gathering-just-a-taste-tickets-39440838610>, if you are not able to go online please contact Judy Vergison 0417 446 425.

We look forward to you joining us at this special Christmas event!

Judy Vergison
Events Co-ordinator

Have you booked yet?

How to Research Your House History Online – 4 November

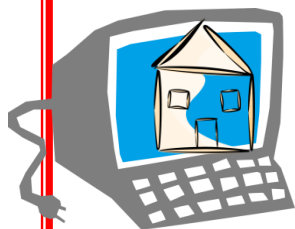

This Glebe Society event is a wonderful opportunity for members (and non-members) to find out a whole lot more about how to research the history of their house online.



When? Saturday 4 November from 11am to 1pm

Where? Main hall, Glebe Town Hall

Tickets: \$10 for members; \$30 for non-members, but \$45 if they join on the night, for which they receive 18 months' membership.

Booking and further information: Registration is essential via <https://www.eventbrite.com.au/e/how-to-research-your-house-online-tickets-38280088776>. If you are unable to book online, please phone Virginia on 0402 153 074, or email her at communications@glebesociety.org.au.

Virginia Simpson-Young
Convenor, Communications

Our House: Rothwell Lodge – 12 November

A special opportunity for Glebe Society members to be a guest in a wonderful Glebe residence, where the owners generously share the stories of their home and surrounds, while you also enjoy socialising with other Glebe residents.

When? Sunday 12 November 2017 2.30-4pm

Where? Rothwell Lodge, 24 Ferry Rd Glebe

Tickets: \$20 pp (Includes refreshments and a tasty selection of cheese/sweet treats)

Bookings and pre-payment are essential as numbers are limited. Bookings via <https://www.eventbrite.com.au/e/our-house-tickets-38279178052>. If you can't use the Society's online Eventbrite booking system call Judy M: 0417 446 425.



Judy Vergison
Events Coordinator

Thirsty Thursday



Glebe Society members and friends are invited to meet in restaurants in and around Glebe, usually on the first Thursday of each month, to eat and talk with other people who

live in Glebe.

We try to pick places where we can share dishes, and have eight or so people at each table. Suggestions and recommendation for restaurants to visit in 2018 are welcome.

Put these details in your 2017 diary now:

- On Thursday 2 November at 7pm we will dine at *Bekya*, Middle Eastern food at the Tramsheds, Harold Park. Enter the Tramsheds from the end of Ross St, or from Maxwell Rd. *Bekya* is close to the restored

tram. *Bekya*, like the other restaurants in the Tramsheds, is licensed (no BYO).

- And on Thursday 7 December at 7pm we will go to *Tommy's Beer Café*, 123 Glebe Point Rd.



Bekya at the Tramsheds
(image: dimmi)

Please email or ring Edwina on 9660 7066 by 6pm on the Wednesday before to let us know if you are coming, or if you are likely to be late.

Edwina Doe

Players in the Pub

Wednesday 15 November 2017 @ 7pm

An Evening with Rumpole's Creator



Directed by Martin Kelly

Upstairs Toxteth Hotel Ferry Rd/Glebe Point Rd Glebe (entry via Ferry Rd stairs)

Free admission. The kitchen is open from 5pm. Please order your food early. We always start on time!

Lyn Collingwood

Fiesta De Tango

Tango Synergy is very excited to be celebrating its 10th Anniversary by presenting Fiesta De Tango on 11th November at Glebe Town Hall. We look forward to welcoming you and your friends to help celebrate this day. There will be free intro tango classes, so invite your non – tango friends to come along to get a taste of the dance that we are all so passionate about.

When: Saturday 11 November, 11am-4pm.

Where: Glebe Town Hall, Sydney Australia

Cost: FREE entry. Wine and light refreshments served.

For more information contact Karan info@tangosynergy.com



Cats and Wildlife in the City

On the morning of Saturday 2 December, the City of Sydney is holding a half day forum entitled 'Cats and Wildlife in the City'.

It will commence at 10am in Glebe Town Hall and will feature talks by Sophie Golding, the City's Urban Ecology Coordinator, Professor

Chris Dickman from the University of Sydney, the Cat Protection Society, Sydney Vets and Australian Wildlife.

The Subcommittee has accepted an invitation to have a table with information about the work of the various bushcare/landcare groups in Glebe.



(image: pexels)

All members of the Society and their friends are welcome to attend.

Andrew Wood
Convenor, Blue Wrens

Lieder and Arias: 28th Annual Glebe Music Festival

Mezzo-soprano Claire Munting with accompanist Simon Kenway will perform at the Glebe Town Hall, Friday 10 November at 7pm.

The recital is entitled: *Rendezvous in Spring*. In the first half, Claire will deliver a Lied repertoire, with music by Manuel de Falla, Gabriel Faure and Richard Strauss.

The second half will be devoted to operatic arias by Verdi, Mascagni and Massenet.

Tickets (\$20/\$15) available in advance at the Glebe Music Festival website, or at the door.

E. David McIntosh AM
Artistic Director
www.glebemusicfestival.com



(image: Facebook)

For your calendar

25 October to 25 November. *Annual Glebe Music Festival*, <http://www.glebemusicfestival.com/>.
 27 October to 12 November *Our City: 175 Years in 175 Objects*. Lower Hall, Sydney Town Hall
 Thursday 2 November, 7pm. *Thirsty Thursday @ Bekya Middle Eastern Kitchen*, Tramsheds.
 Saturday 4 November, 11am-1pm. *Researching Your House Online*. Glebe Town Hall.
 Friday 10 November, 7pm. *Glebe Music Festival: 'Rendezvous in Spring'*. Glebe Town Hall
 Saturday 11 November, 11am-4pm. *Fiesta de Tango*, Glebe Town Hall
 Sunday 12 November, 2.30-4pm. *Our House* – Rothwell House in Ferry Rd.
 Wednesday 15 November 2017, 7pm, *Players in the Pub*, Toxteth Hotel
 Saturday 2 December, 10am. *Cats and Wildlife in the City*, Glebe Town Hall
 Sunday 3 December, 5.30-8pm. *Christmas Party*, Glebe Town Hall.
 Thursday 7 December, 7pm. *Thirsty Thursday @ Tommy's Beer Café*, 123 Glebe Point Rd,
 Saturday 9 December, 7pm. *Vicki Pogulis' Retirement Party*, 16 Eveleigh St Redfern
 Wednesday mornings from 8.30am. *Glebe Bushcare Group*, near Jubilee Park. Contact Sue – 9692 9161.

Glebe Society Inc. Established 1969

Management Committee

President	Allan Hogan	0411 607 813	president@glebesociety.org.au
Vice President	Diane Hutchinson	0407 207 177	vicepresident@glebesociety.org.au
Past President	Ted McKeown	02 9660 3917	pastpresident@glebesociety.org.au
Secretary	Jude Paul	0438 600 882	secretary@glebesociety.org.au
Minutes Secretary	Jane Gatwood (temp)	0488 118 355	minutes@glebesociety.org.au
Treasurer	Jane Gatwood	0488 118 355	treasurer@glebesociety.org.au
Ordinary member	Nick Hespe	0401 453 992	nick@glebesociety.org.au
Ordinary member	Janet Wahlquist		janet@glebesociety.org.au
Ordinary member	Murray Jewell	0405 921 945	transport@glebesociety.org.au
Ordinary member	(vacancy)		
Bays & Foreshores	Lesley Lynch	02 9660 5084	bays@glebesociety.org.au
Blue Wrens	Andrew Wood	02 9660 6104	bluewrens@glebesociety.org.au
Communications	Virginia Simpson-Young	0402 153 074	communications@glebesociety.org.au
Community	Janice Challinor	0401 505 657	community@glebesociety.org.au
Environment	Asa Wahlquist	02 9660 8261	environment@glebesociety.org.au
Heritage	Ted McKeown	02 9660 3917	heritage@glebesociety.org.au
Planning	Neil Macindoe	02 9660 0208	planning@glebesociety.org.au
Transport & Traffic	Murray Jewell	0405 921 945	transport@glebesociety.org.au

Working Groups & Contacts

Glebe Island Bridge	Murray Jewell	0405 921 945	transport@glebesociety.org.au
Archivist	Lyn Milton	02 9660 7930	milton.lyn@gmail.com
<i>Bulletin</i> Editor	Virginia Simpson-Young	0402 153 074	editor@glebesociety.org.au
Events	Judy Vergison	02 9692 9200	events@glebesociety.org.au
History	Lyn Collingwood	02 9660 5817	lyncol1@optusnet.com.au
History of Glebe	Max Solling	02 9660 1160	
Webmaster	Andrew Botros	0402 112 106	webmaster@glebesociety.org.au
Website technical	Peter Thorogood	0404 801 947	support@glebesociety.org.au
Chief Twit	Allan Hogan	0411 607 813	twitter@glebesociety.org.au

Highlights this Issue

GARDENING AUSTRALIA FILMS IN GLEBE	1
WESTCONNEX: COMMUNITIES SHOW THEIR DISTASTE FOR A BAD PROJECT	1
PLANNING REPORT, BY NEIL MACINDOE	2
WHO LIVED IN THESE HOUSES? BY RODNEY HAMMETT. NORTHCOTE RD – THE FIRST OWNERS AND OCCUPANTS	3
EXHIBITION - OUR CITY: 175 YEARS IN 175 OBJECTS	7
WHO LIVED IN YOUR STREET? BY LYN COLLINGWOOD: GEORGE BOWEN (1892-1917)	7
SUNSET SOIRÉE FOR CENTIPEDE	8
CHRISTMAS GIFTS FOR GLEBE'S TEMPORARY RESIDENTS	9
VICKI POGULIS' RETIREMENT PARTY	9
THE GLEBE SOCIETY CHRISTMAS GATHERING	10
HAVE YOU BOOKED YET? HOW TO RESEARCH YOUR HOUSE HISTORY ONLINE – 4 NOVEMBER; OUR HOUSE: ROTHWELL LODGE – 12 NOVEMBER ..	11
THIRSTY THURSDAY	11
PLAYERS IN THE PUB; FIESTA DE TANGO; CATS AND WILDLIFE IN THE CITY; LIEDER AND ARIAS: 28TH ANNUAL GLEBE MUSIC FESTIVAL	12



PO Box 100 GLEBE NSW 2037

No.9 of 2017 (November)

Membership of the Glebe Society

- Individual member: \$45
- Joint (2 people, one address): \$55
- Household: \$60
- Concession (student or pensioner): \$20
- Institution or corporate: \$110

How to join

- Join online: complete the Membership Application on our website under 'Membership'
- Download a membership form from www.glebesociety.org.au; or
- Write to the Secretary at PO Box 100 Glebe 2037; or
- Email secretary@glebesociety.org.au



Mim cat stencil in Glebe (Image: JAM Project)