



THE GLEBE SOCIETY BULLETIN

Box 100, Glebe 2037

7/1982

SEPTEMBER

MANAGEMENT COMMITTEE MEETING

Parks

1. John Buckingham reported on the 25th July Bicentennial Park meeting, which had satisfactory attendance, although a little disappointing given the fine weather. For a full report, see separate article.)
2. It is envisaged that a police band recital will be arranged for the opening ceremony of the Blackwattle Bay Park.

Treasurer's Report

The Treasurer reported concern at the low number of subscriptions received. Non-subscribers will be reminded that they will not receive copies of the Bulletin after September, unless they pay their subscription promptly.



Race meetings

It was noted that both Wentworth Park and Harold Park have been granted extra race nights by the State Government. The Committee agreed to send a strong letter of protest.



A DAY AT HABERFIELD

Members and friends of The Haberfield Association are invited to a day of House Inspections at Haberfield arranged by the Women's Committee of The National Trust of Australia (NSW) on Saturday October 16 from 10.30 am to 4.00 pm.

Some fine examples of Federation architecture with Art Nouveau interiors and recent restorations will be seen at this historic Garden Suburb.

The Haberfield Association's Market Day will be held on this day at Dickson Street and St. Oswald's Anglican Church Hall with a variety of stalls and goods for sale.

The Ashfield and District Historical Society will present an exhibition **Historical Haberfield** and mini-bus tours and walking tour notes are available.

Lunches and Devonshire Teas will be provided by The Haberfield Association. Inquiries: Telephone 798 7447 or 798 3835.

For tickets for the House Inspections at \$3 for Trust members and \$5 for friends, please write, enclosing a stamped addressed envelope to — Ticket Secretary, National Trust Women's Committee, P.O. Box 53 Edgecliff 2027.

Telephone: 32 2401 between 10.30 am and 1 pm Monday to Friday.

Please note that House Inspections are for Ticket Holders Only.

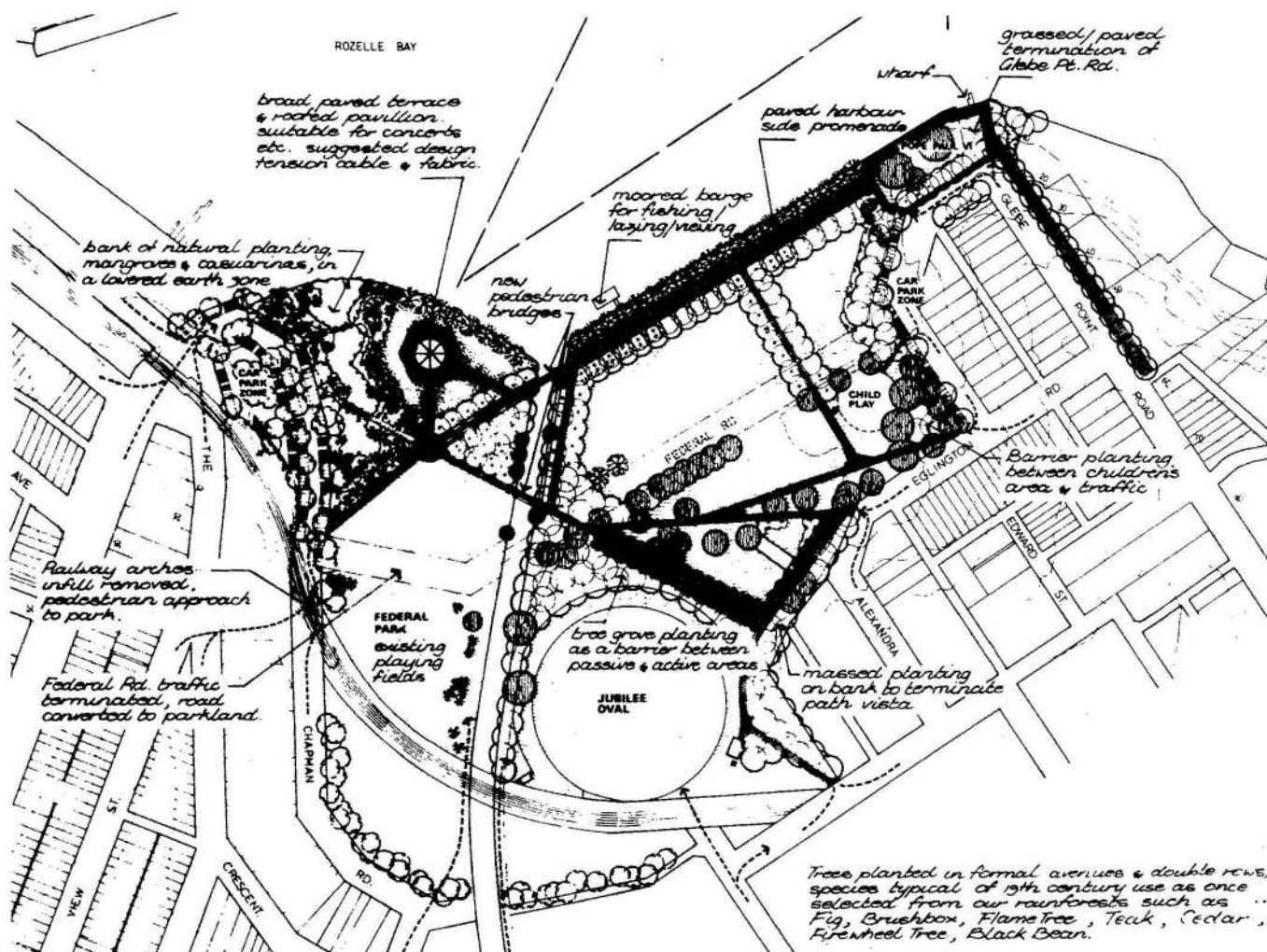

BI-CENTENNIAL PARK — Rozelle Bay

Further publicity for this large and important project resulted from a meeting in Jubilee Park on Sunday, 25th July at 11am. The meeting had been extensively advertised, particularly in shop windows, and the crowd of about seventy was enthusiastic.

John Buckingham outlined the history of the site, stressing the period when the waterfront was far more accessible than it is now. He made the merits of the Bruce McKenzie plan for a bi-centennial park clear (the design is currently used as a model for council bi-centennial proposals) and brought us up to date on current negotiations with the Minister for Ports, Jack Ferguson.

Mr Ferguson has yet to make a final decision on the bi-centennial park proposals. John Buckingham urged the meeting to ensure the Minister's approval by writing to both Ferguson and our local member, Pat Hills to encourage them to transfer the land from the Maritime Services Board to Leichhardt Council.

John stressed that the letters should convey the personal concern of members about such issues as lack of open space in Glebe, especially on the waterfront; the splendid conception and design of the plan itself, which would benefit not only Glebe and Annandale but the whole inner-city region; the current ugly appearance and inappropriate use of the site for storage of timber, and the adequate space available elsewhere for this purpose; and the fact that short leases and empty sites make it opportune now to re-create this only really substantial area left in Glebe as parkland.

Members are asked to familiarize themselves with the plan, acquaint their neighbours with it, and write letters endorsing the proposal to the following people as soon as possible:

Hon. Jack Ferguson, MLA
Minister for Ports,
Parliament House,
Macquarie Street,
SYDNEY 2000

Hon. Pat Hills, MLA
Member for Elizabeth,
Parliament House,
Macquarie Street,
SYDNEY 2000

ANNUAL GENERAL MEETING held 11th August, 1982

The President's Report was printed in the last edition of the Bulletin. The meeting also received reports from the Treasurer, the Residents' Planning Committee, Parks and Open Spaces, and Local History.

Residents' Planning Committee

Alan Robertson reported.

- a) **The Town Plan** In response to the planning Board's request, the Leichhardt Council supplied detailed plans with specific justification for the reductions in residential densities in the new Town Plan. However, the Planning Director had peremptorily rejected Council's proposals, presumably a politically motivated decision.
- b) **The University Hall** development proposal is now approved, with balconies to be restored, and development in the rear to be substantial. Accommodation is to be leased and confined to University staff and students.
- c) **The 461-5 Glebe Point Road** development plan is now down to 33 large units, with three storeys facing the waterfront. Open waterfront space is to go to the Leichhardt Council, and eventually to connect to the Blackwattle Bay Park. However, the situation is dangerous as the rezoning is not specific to the proposed development.
- d) **The Bird and Lucas** site has been rezoned according to and approved plan.
- e) **The Glebe High School** is going ahead, but the TAFE proposal status is not known.
- f) **The Glebe Point** bus shelter and staff toilets are being rebuilt to fit in with Glebe.
- g) **The 47-51 Hereford St** site development application went to the Land and Environment Court where No. 47 was saved but the rest lost to unsatisfactory development.
- h) \$37,000 is available to restore **Venetia**.
- i) Leichhardt Council has not taken **Lyndhurst** over from the DMR, but has asked to be involved in planning.

Parks and Open Spaces

This report was delivered by John Buckingham and Bob Armstrong.

They particularly noted the change to working with Council rather than fighting them. Bicentennial Park is being promoted and supported, and the Blackwattle Bay Park has been something of a win. However, with little money, not much otherwise can be done, and the inland parts of Glebe are particularly disadvantaged. Various plans have been variously frustrated. The Year of the Tree is being followed up to improve the greening of Glebe.

Local History

Max Solling reported that in the last 12 months several talks had been given, and a paper on oral evidence presented. A history walk was held in April for members of the Society. Local publications include centenary histories of two local Masonic Lodges, and a history of the Children's Hospital in Glebe. Considerable work has been done on Glebe history of the First World War period, this including compilations of enlistments and deaths, study of activities of the Glebe Anti-German League, the tensions created over conscription, and the referendum on hotel trading hours. Two more issues of the Leichhardt History Journal should be published soon, and more talks on local matters are planned for the coming year.

Elections

The Glebe Society Management Committee election results were as follows:

President:	Doris Sharpe
Senior Vice President:	Bob Armstrong
Junior Vice President:	Neville Holmes
Secretary:	Richard Lauder
Treasurer:	John Priest
Committee:	Jo Bastian
	Eileen Lacey
	Rita Ramsden
	Gladys Reid (New Members' Representative)
	Peter Vester

Maureen Colman is also a member of the Committee ex officio, as Immediate Past President.

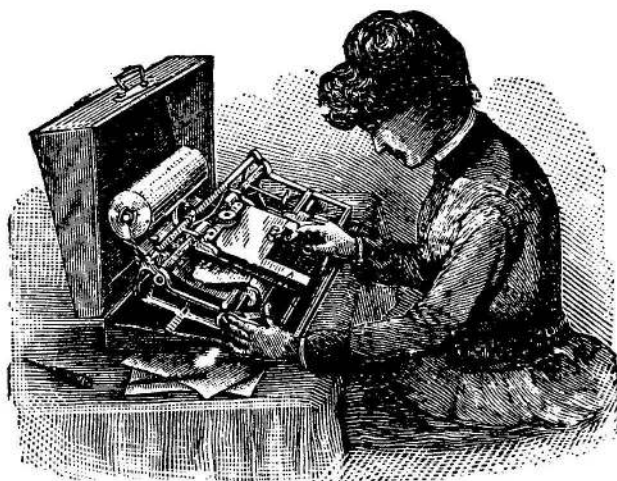

HELP WANTED

A volunteer is needed to take on the task of editing The Glebe Society Bulletin. It is a very interesting job, which allows you to become involved in the Society's activities, and meet other members.

The work involved includes collection of articles, usually some writing, and preparation of the material for the printer. It is a considerable advantage if the editor is able to type (and owns his or her own typewriter), but if you would like to volunteer and don't type, please discuss the situation with the present editor.

For further information ring Jan Macindoe, 660 0208.



MANAGEMENT COMMITTEE

President	Doris Sharpe	660 6636
Senior Vice Pres.	Bob Armstrong	660 4189
Junior Vice Pres.	Neville Holmes	692 0247
Secretary	Richard Lauder	660 3254
Treasurer	John Priest	660 3543
Committee	Jo Bastian	660 7107
	Eileen Lacey	692 0173
	Peter Vester	660 1875
New members rep.	Gladys Reid	692 0204
Bulletin editor	Jan Macindoe	660 0208
Bulletin distribution	Neil Macindoe	660 0208
Phototypeset by	Helen Deller	660 7428

FOR YOUR DIARY

Sunday, 19th September, 11a.m. — 1p.m.

Coffee morning at the home of Rita Ramsden, 171 Arundel Street, Glebe. New members always welcome.

Monday, 20th September

The Monday Group will visit The Botanic Garden, and have lunch at The Kiosk. Catch the 11a.m. bus from Glebe Point.

Monday, 18th October

The Monday Group will be making a trip to Bowral for the Tulip Festival and having lunch at Anna Forknall's. For further information ring Vi Hicks, 660 3694.

Monday, 15th November, 2.30p.m.

The Monday Group will have afternoon tea at the home of Bara Marsh, 3 Victoria Road, Glebe.

SOCIAL COMMITTEE

A new Social Committee will be formed at the first meeting of the new Management Committee, which will be early in September. No doubt the new committee will have many plans for future activities, and will be eager to hear your suggestions, but in the meantime, there is a short lull in our plans for social events!